

02-14 REAR SUSPENSION

REAR SUSPENSION LOCATION

INDEX 02-14-2

REAR SHOCK ABSORBER

REMOVAL/INSTALLATION 02-14-3

Rear Shock Absorber Removal
Note 02-14-3

REAR SHOCK ABSORBER

INSPECTION 02-14-3

REAR SHOCK ABSORBER

DISPOSAL 02-14-3

REAR COIL SPRING

REMOVAL/INSTALLATION 02-14-4

Rear Lower Arm Outer Bolt Removal
Note 02-14-4

Rear Coil Spring Installation Note 02-14-5

REAR LOWER ARM

REMOVAL/INSTALLATION 02-14-5

REAR LATERAL LINK

REMOVAL/INSTALLATION 02-14-6

Rear Lower Arm Outer Bolt Removal
Note 02-14-6

Rear Lateral Link Installation Note 02-14-6

REAR UPPER ARM

REMOVAL/INSTALLATION 02-14-7

Rear Lower Arm Outer Bolt
Removal Note 02-14-7

Rear Upper Arm Installation Note 02-14-8

REAR TRAILING LINK

REMOVAL/INSTALLATION 02-14-8

Brake Caliper Component Removal
Note 02-14-9

Rear Lateral Link Outer Bolt
Removal Note 02-14-9

Rear Trailing Link Installation Note 02-14-9

REAR STABILIZER

REMOVAL/INSTALLATION 02-14-10

Stabilizer Bracket Removal Note 02-14-10

Stabilizer Bushing Installation Note 02-14-11

Stabilizer Bracket Installation Note 02-14-11

Rear Stabilizer Component
Installation Note 02-14-12

STABILIZER CONTROL LINK

INSPECTION 02-14-12

REAR CROSSMEMBER

REMOVAL/INSTALLATION 02-14-12

Rear Crossmember Removal Note 02-14-13

02-14

REAR SUSPENSION

REAR SUSPENSION LOCATION INDEX

id021400800400

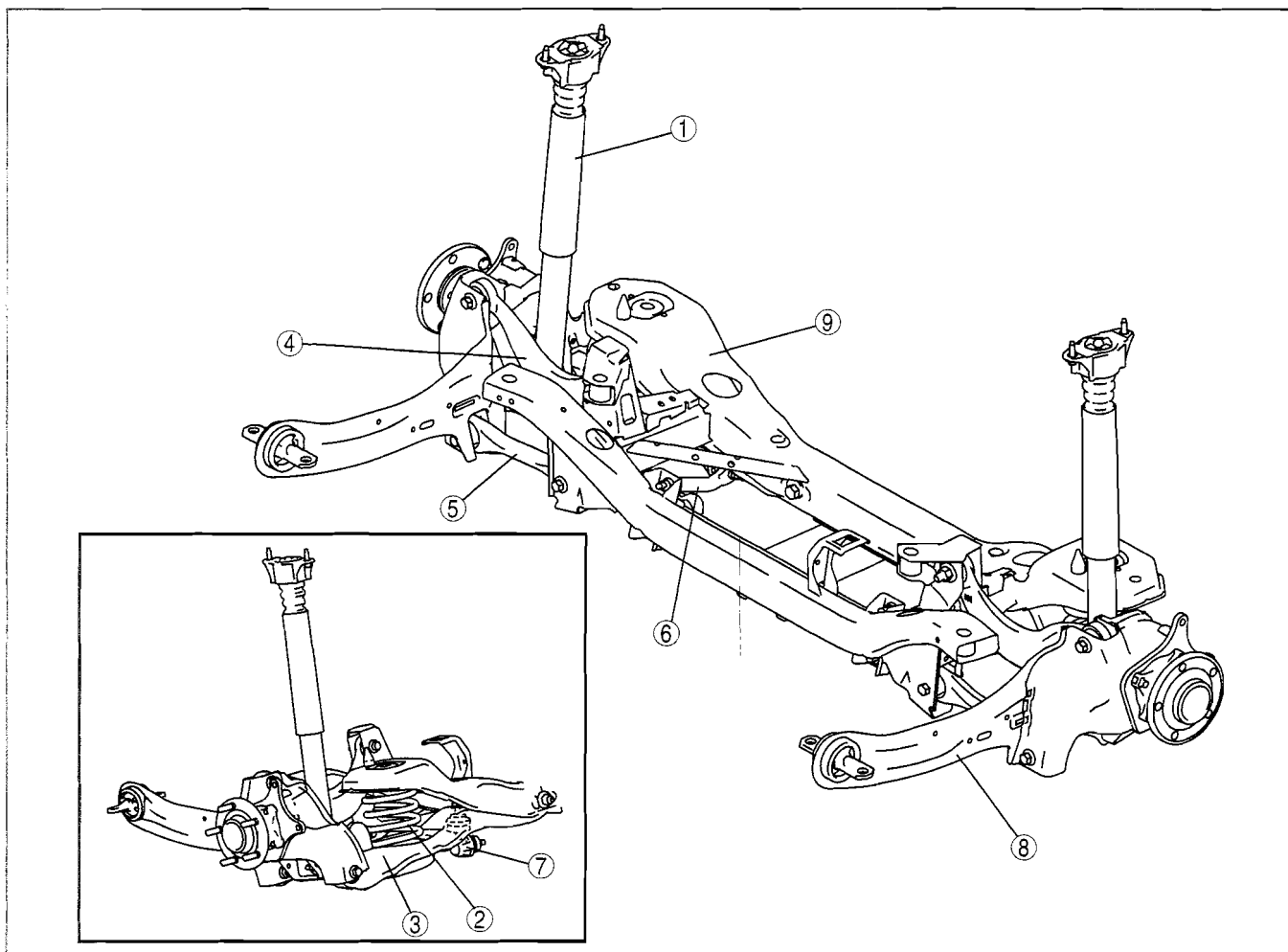

B3E0214W001

1	Rear shock absorber (See 02-14-3 REAR SHOCK ABSORBER REMOVAL/INSTALLATION.) (See 02-14-3 REAR SHOCK ABSORBER INSPECTION.) (See 02-14-3 REAR SHOCK ABSORBER DISPOSAL.)
2	Rear coil spring (See 02-14-4 REAR COIL SPRING REMOVAL/INSTALLATION.)
3	Rear lower arm (See 02-14-5 REAR LOWER ARM REMOVAL/INSTALLATION.)
4	Rear upper arm (See 02-14-7 REAR UPPER ARM REMOVAL/INSTALLATION.)

5	Rear lateral link (See 02-14-6 REAR LATERAL LINK REMOVAL/INSTALLATION.)
6	Rear stabilizer (See 02-14-10 REAR STABILIZER REMOVAL/INSTALLATION.)
7	Stabilizer control link (See 02-14-12 STABILIZER CONTROL LINK INSPECTION.)
8	Rear trailing link (See 02-14-8 REAR TRAILING LINK REMOVAL/INSTALLATION.)
9	Rear crossmember (See 02-14-12 REAR CROSSMEMBER REMOVAL/INSTALLATION.)

REAR SUSPENSION

REAR SHOCK ABSORBER REMOVAL/INSTALLATION

id021400801300

1. Remove in the order indicated in the table.

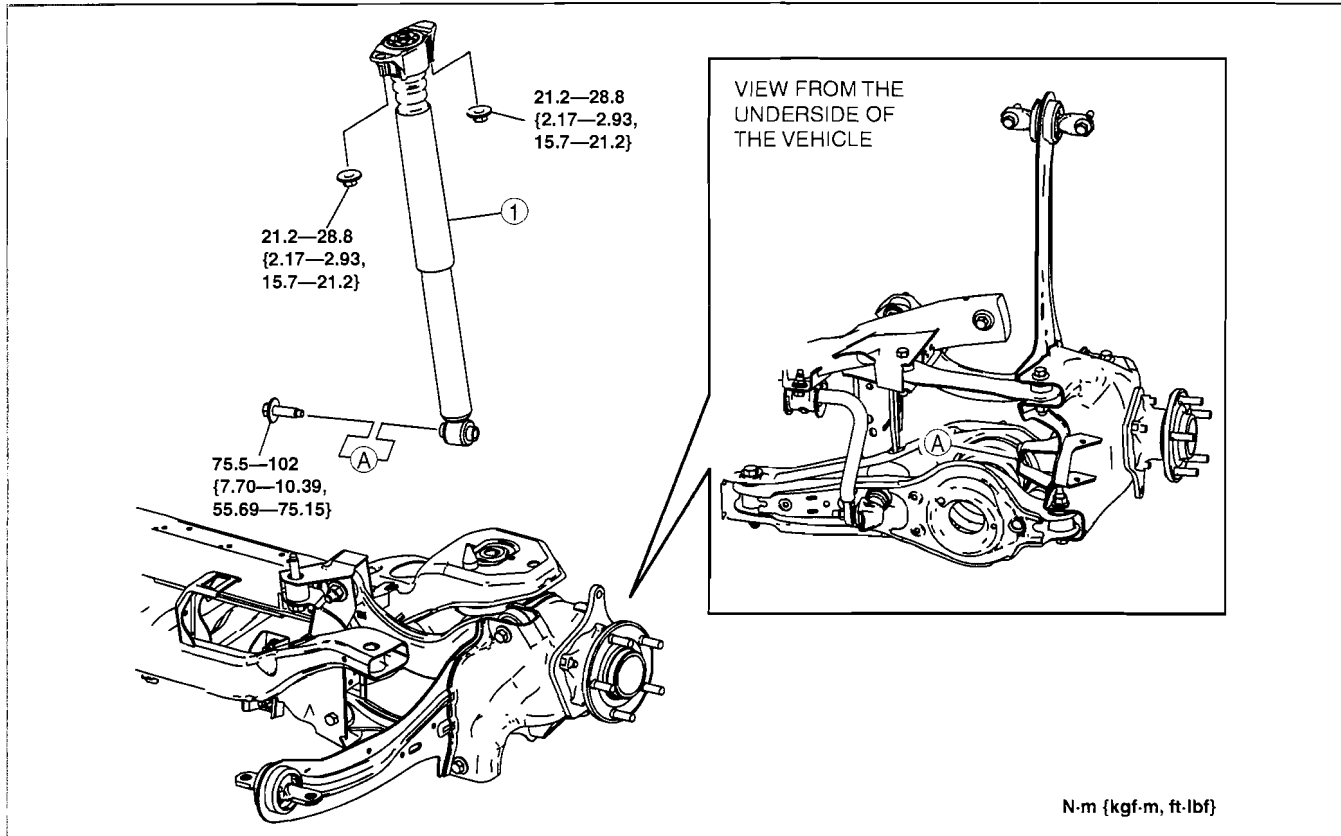

02-14

e3u214zw6005

1	Rear shock absorber (See 02-14-3 Rear Shock Absorber Removal Note.)
---	--

2. Install in the reverse order of removal.

Rear Shock Absorber Removal Note

1. Support the rear axle using a jack.
2. Remove the rear shock absorber.

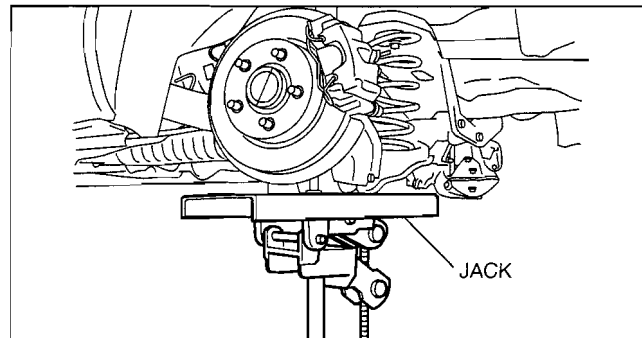

am3uuw000089

REAR SHOCK ABSORBER INSPECTION

id021400801400

1. Inspect in the same way as the front shock absorber.
(See 02-13-8 FRONT SHOCK ABSORBER INSPECTION.)

REAR SHOCK ABSORBER DISPOSAL

id021400801500

1. Dispose of the rear shock absorber in the same way as the front shock absorber.
(See 02-13-8 FRONT SHOCK ABSORBER DISPOSAL.)

REAR SUSPENSION

REAR COIL SPRING REMOVAL/INSTALLATION

id021400800700

1. Remove the rear stabilizer. (See 02-14-10 REAR STABILIZER REMOVAL/INSTALLATION.)
2. Remove in the order indicated in the table.
3. Install in the reverse order of removal.
4. Inspect the wheel alignment and adjust it if necessary. (See 02-11-4 REAR WHEEL ALIGNMENT.)

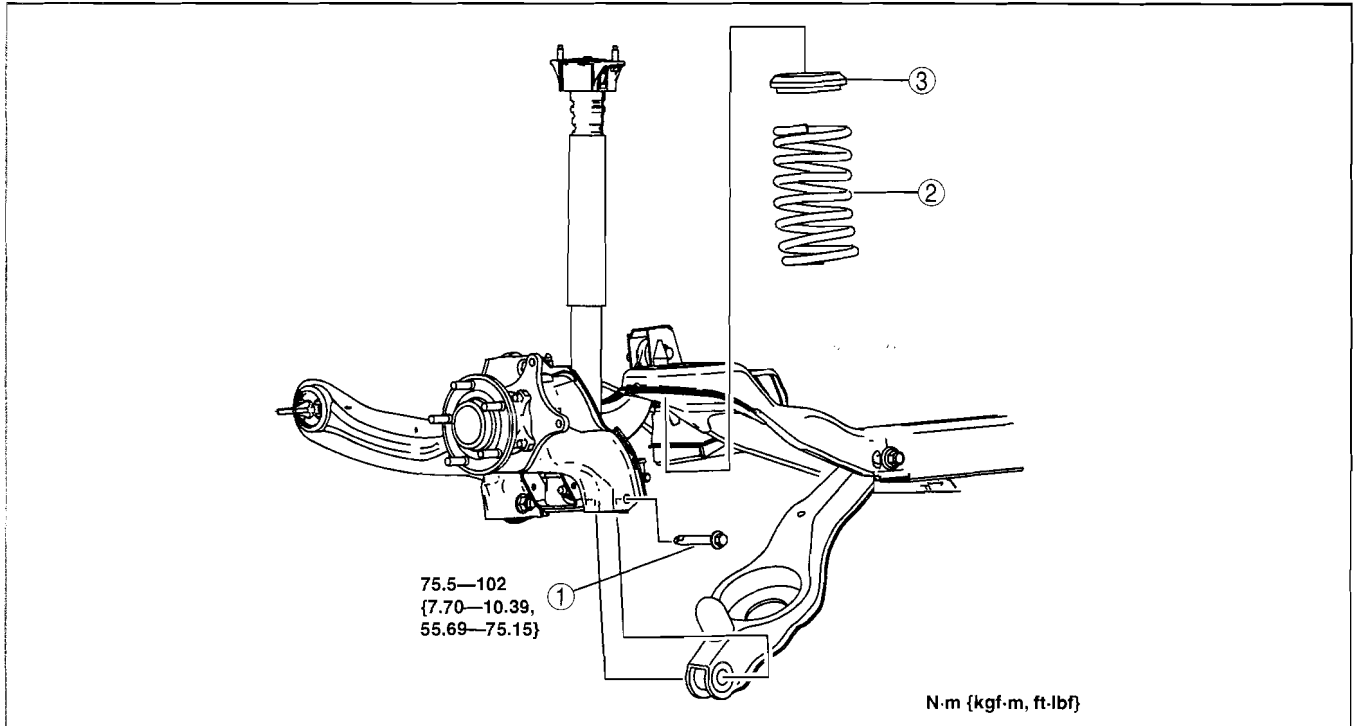

e3u214zw6004

1	Rear lower arm outer bolt (See 02-14-4 Rear Lower Arm Outer Bolt Removal Note.)
---	--

2	Rear coil spring (See 02-14-5 Rear Coil Spring Installation Note.)
3	Upper spring seat rubber

Rear Lower Arm Outer Bolt Removal Note

1. Support the rear lower arm using a jack.
2. Loosen the rear lower arm inner bolt.
3. Remove the rear lower arm outer bolt.

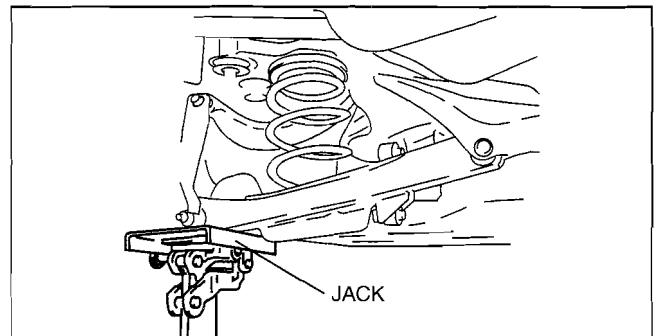

am3uuw000088

REAR SUSPENSION

Rear Coil Spring Installation Note

1. Position the jack under the rear lower arm and jack up slowly.

Warning

- Installing the coil spring is dangerous. The coil spring could fly off and cause serious injury or death, and damage the vehicle.

2. Align the upper end of the rear coil spring with the step of the upper spring seat rubber.
3. Align the lower end of the rear coil spring with the step of the lower spring seat rubber.
4. Install the lower arm outer bolt.

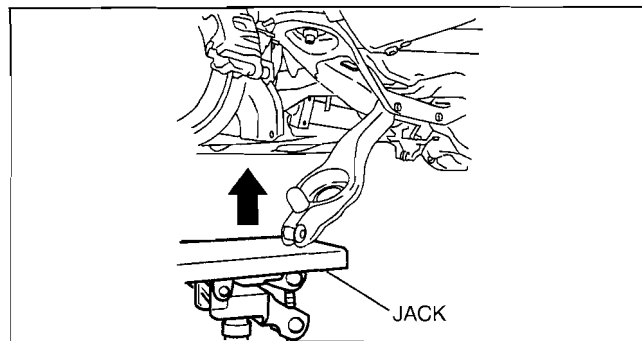

am3uuw000088

02-14

REAR LOWER ARM REMOVAL/INSTALLATION

id02140080900

1. Remove in the order indicated in the table.
2. Install in the reverse order of removal.
3. Inspect the wheel alignment and adjust it if necessary. (See 02-11-4 REAR WHEEL ALIGNMENT.)

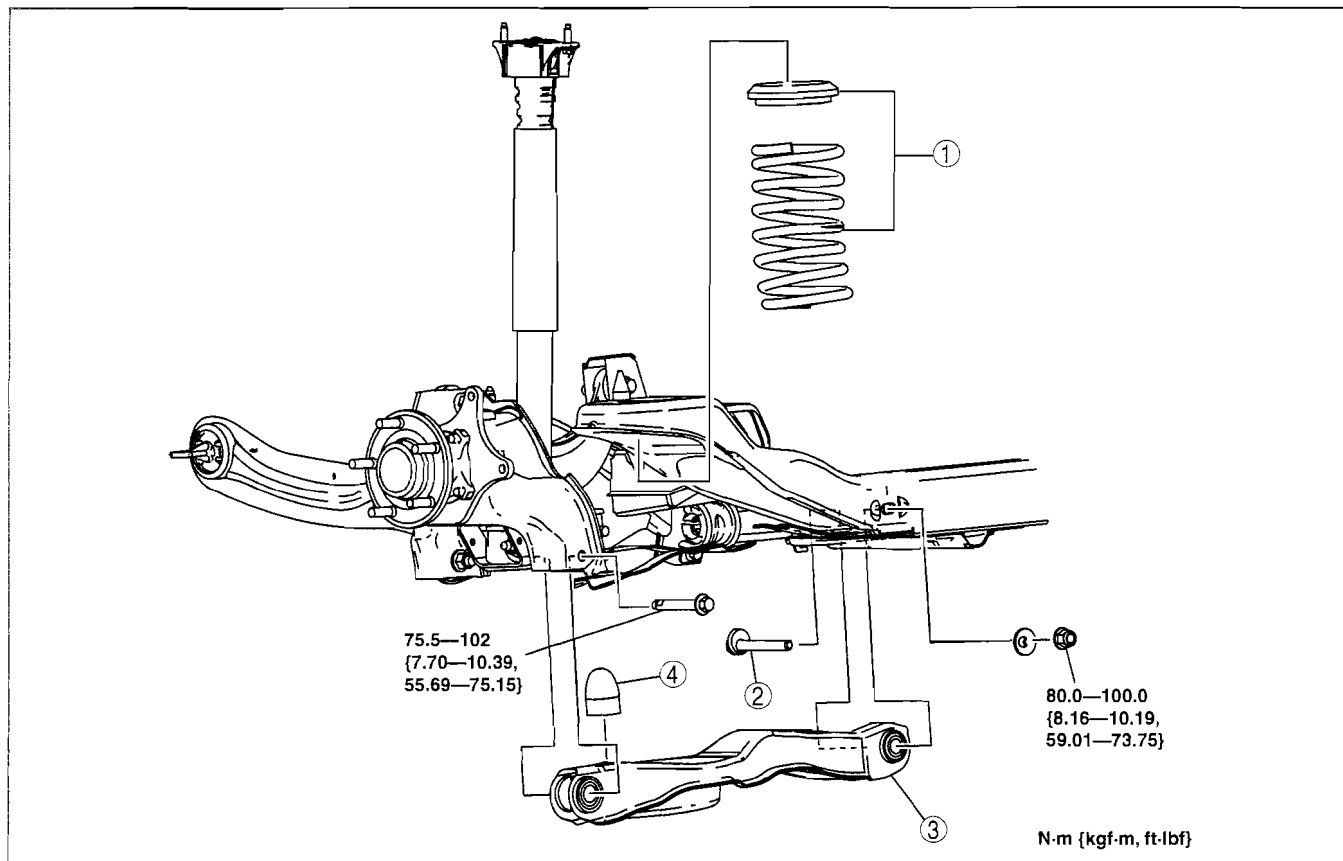

e3u214zw6006

1	Rear coil spring component (See 02-14-4 REAR COIL SPRING REMOVAL/ INSTALLATION.)
---	--

2	Rear lower arm inner bolt
3	Rear lower arm
4	Bound stopper

REAR SUSPENSION

REAR LATERAL LINK REMOVAL/INSTALLATION

id021400801200

1. Remove the rear stabilizer. (See 02-14-10 REAR STABILIZER REMOVAL/INSTALLATION.)
2. Remove in the order indicated in the table.
3. Install in the reverse order of removal.
4. Inspect the wheel alignment and adjust it if necessary. (See 02-11-4 REAR WHEEL ALIGNMENT.)

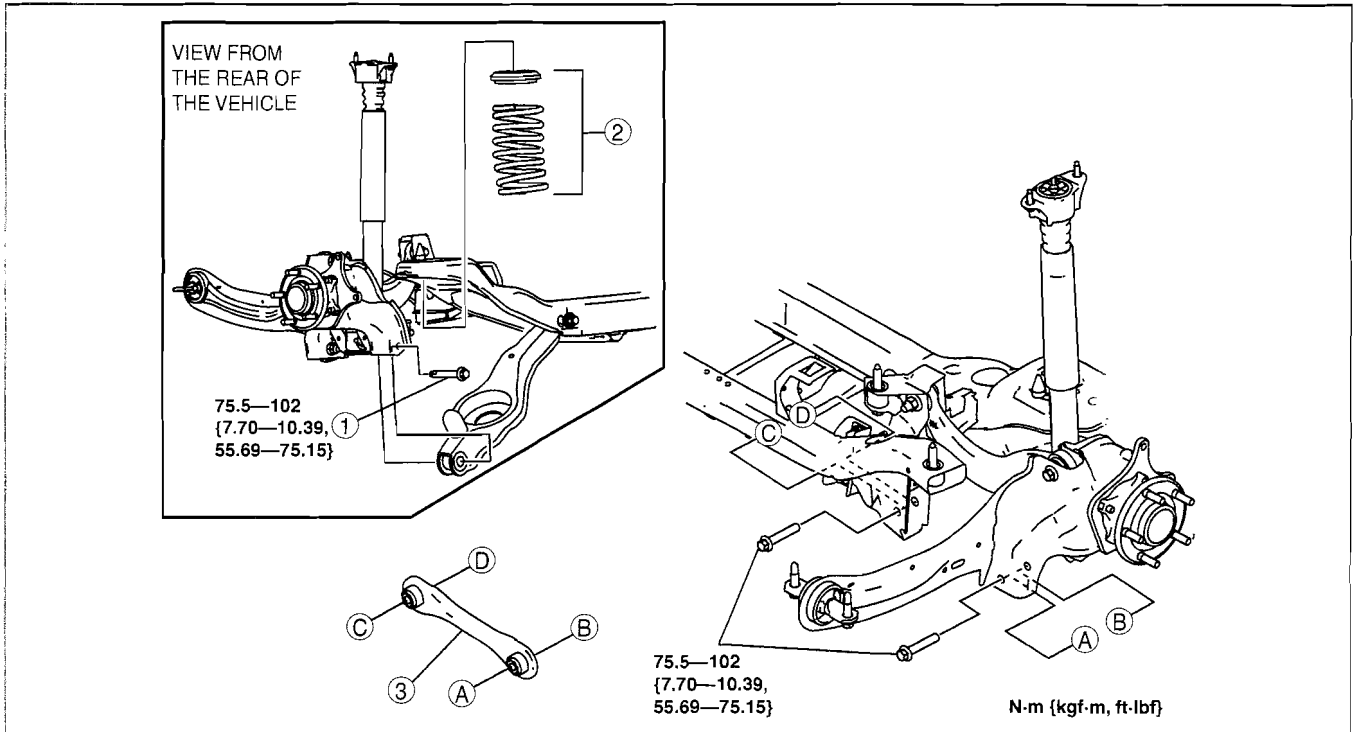

e3u214zw6003

1	Rear lower arm outer bolt (See 02-14-6 Rear Lower Arm Outer Bolt Removal Note.)
---	--

2	Rear coil spring component (See 02-14-4 REAR COIL SPRING REMOVAL/INSTALLATION.)
3	Rear lateral link (See 02-14-6 Rear Lateral Link Installation Note.)

Rear Lower Arm Outer Bolt Removal Note

1. Support the rear lower arm using a jack.
2. Loosen the rear lower arm inner bolt.
3. Remove the rear lower arm outer bolt.

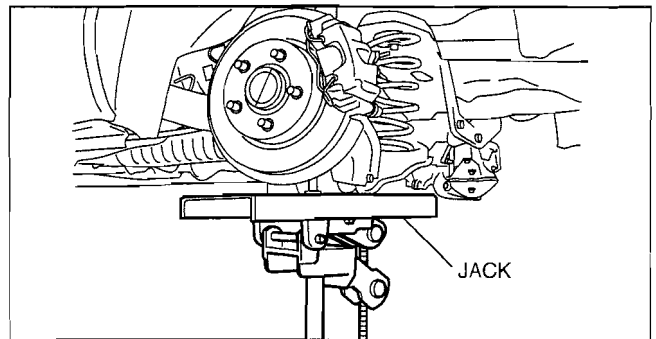

am3uuw0000089

Rear Lateral Link Installation Note

1. Install the rear lateral link so that the rib is facing toward the front of the vehicle.

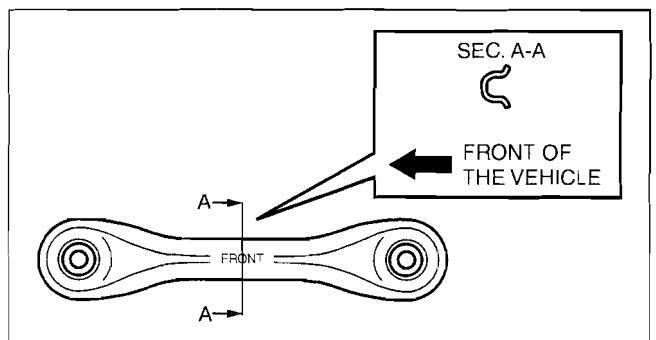

am3uuw0000089

REAR SUSPENSION

REAR UPPER ARM REMOVAL/INSTALLATION

id021400800800

1. Remove the evaporative mission (EVAP) system leak detection pump. (See 01-16A-9 EVAPORATIVE EMISSION (EVAP) SYSTEM LEAK DETECTION PUMP REMOVAL/INSTALLATION[L3].) (See 01-16B-7 EVAPORATIVE EMISSION (EVAP) SYSTEM LEAK DETECTION PUMP REMOVAL/INSTALLATION[L3 WITH TC].)
2. Remove in the order indicated in the table.
3. Install in the reverse order of removal.
4. Inspect the wheel alignment and adjust it if necessary. (See 02-11-4 REAR WHEEL ALIGNMENT.)

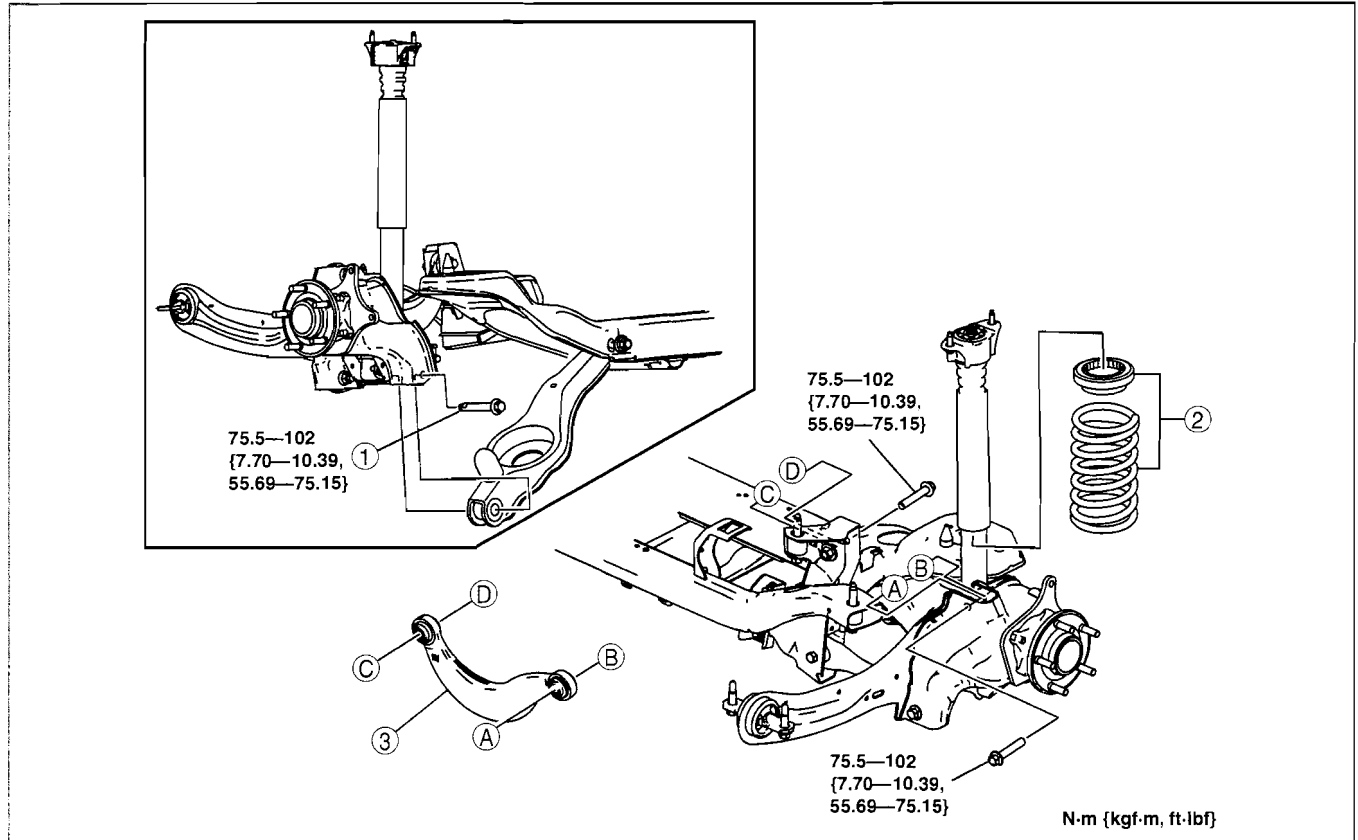

02-14

e3u214zw6002

1	Rear lower arm outer bolt (See 02-14-7 Rear Lower Arm Outer Bolt Removal Note.)
---	--

2	Rear coil spring component (See 02-14-4 REAR COIL SPRING REMOVAL/INSTALLATION.)
3	Rear upper arm (See 02-14-8 Rear Upper Arm Installation Note.)

Rear Lower Arm Outer Bolt Removal Note

1. Support the rear lower arm using a jack.
2. Loosen the rear lower arm inner bolt.
3. Remove the rear lower arm outer bolt.

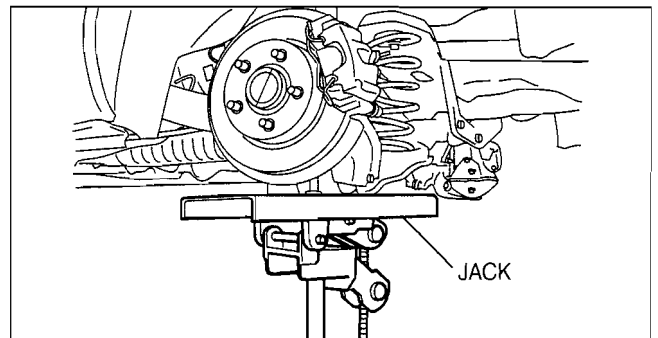

am3uuw0000088

REAR SUSPENSION

Rear Upper Arm Installation Note

1. Install the rear upper arm so that IN mark is facing toward the inside of the vehicle.

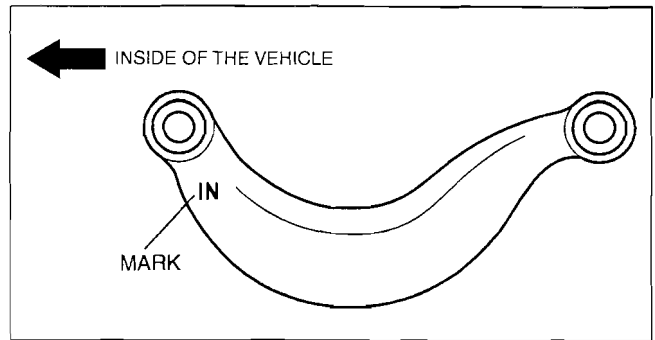

am3uuw000089

REAR TRAILING LINK REMOVAL/INSTALLATION

id021400802000

Caution

- Performing the following procedures without first removing the ABS wheel-speed sensor may possibly cause an open circuit in the wiring harness if it is pulled by mistake. Before performing the following procedures, disconnect the ABS wheel-speed sensor wiring harness connector (axle side) and fix the wiring harness to an appropriate place where it will not be pulled by mistake while servicing the vehicle.

1. Remove in the order indicated in the table.
2. Install in the reverse order of removal.
3. Inspect the wheel alignment and adjust it if necessary. (See 02-11-4 REAR WHEEL ALIGNMENT.)

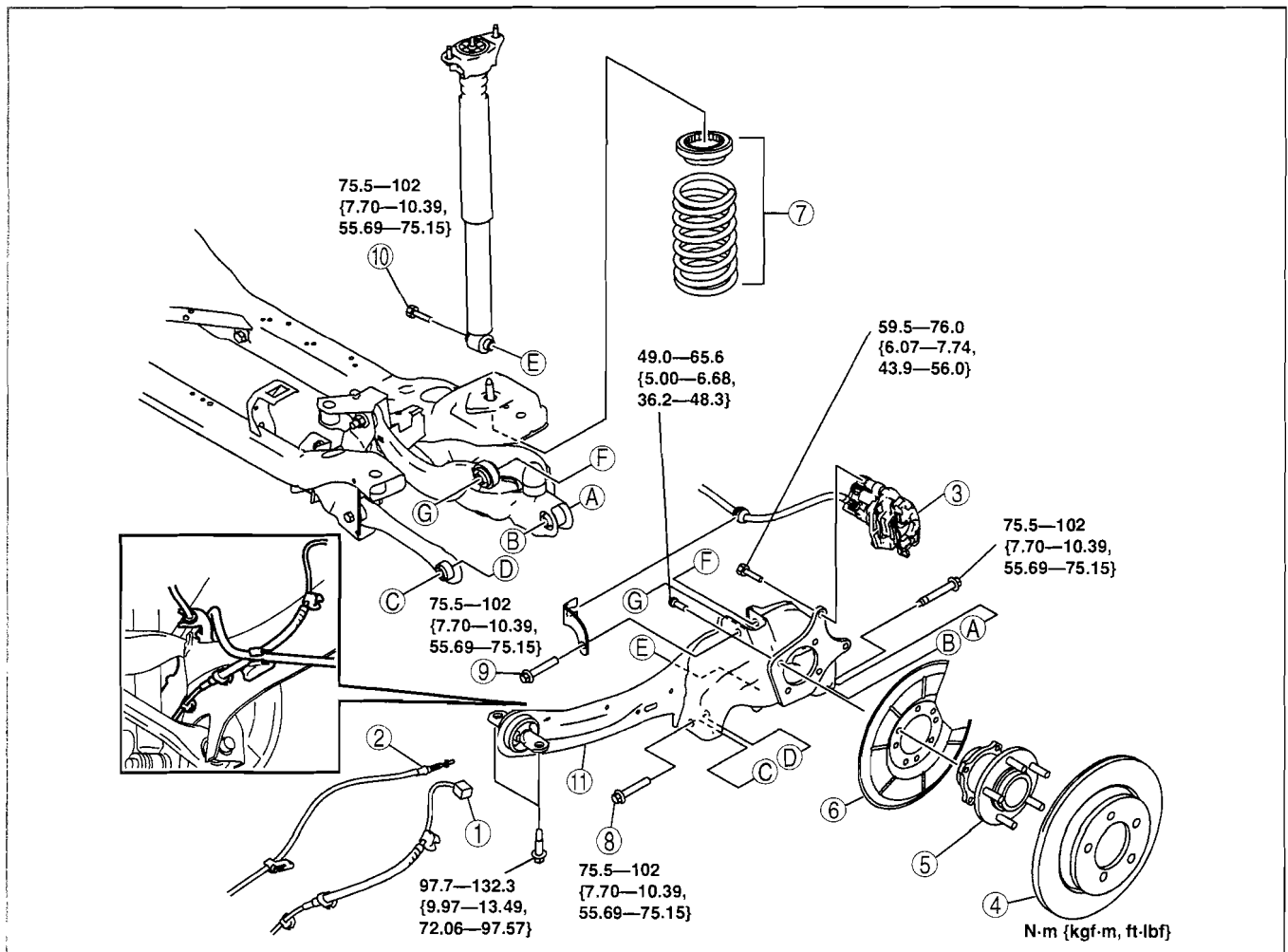

e3u214zw6007

REAR SUSPENSION

1	ABS wheel-speed sensor wiring harness connector
2	Rear parking brake cable (See 04-12-2 PARKING BRAKE LEVER REMOVAL/ INSTALLATION.)
3	Brake caliper component (See 02-14-9 Brake Caliper Component Removal Note.)
4	Disc plate
5	Rear hub component
6	Dust cover

7	Rear coil spring component (See 02-14-4 REAR COIL SPRING REMOVAL/ INSTALLATION.)
8	Rear lateral link outer bolt (See 02-14-9 Rear Lateral Link Outer Bolt Removal Note.)
9	Rear upper arm outer bolt
10	Rear shock absorber lower bolt
11	Rear trailing link (See 02-14-9 Rear Trailing Link Installation Note.)

02-14

Brake Caliper Component Removal Note

1. Hang the caliper component using a cable and move aside.

Rear Lateral Link Outer Bolt Removal Note

1. Support the trailing link using a jack.

Caution

- Verify that the trailing link is securely supported by a jack. If the trailing link falls off, it can cause serious injury or death, and damage to the vehicle.

2. Remove the rear lateral link outer bolt.

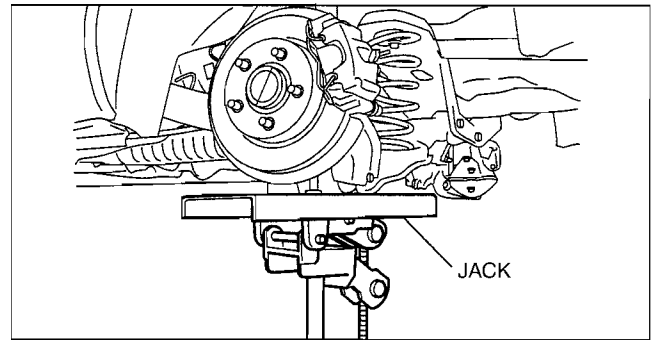

am3uuw000089

Rear Trailing Link Installation Note

1. Support the trailing link using a jack.
2. Tighten the trailing link front side bolts.

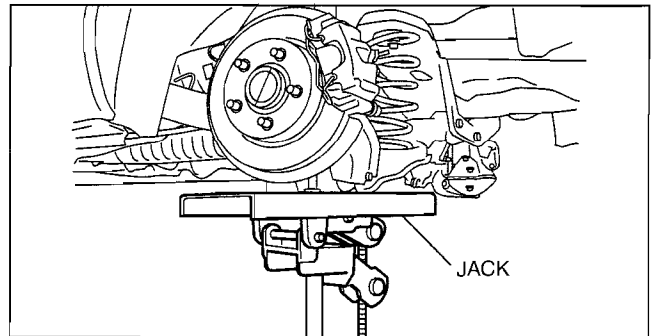

am3uuw000089

REAR SUSPENSION

REAR STABILIZER REMOVAL/INSTALLATION

id021400800500

1. Remove in the order indicated in the table.
2. Install in the reverse order of removal.

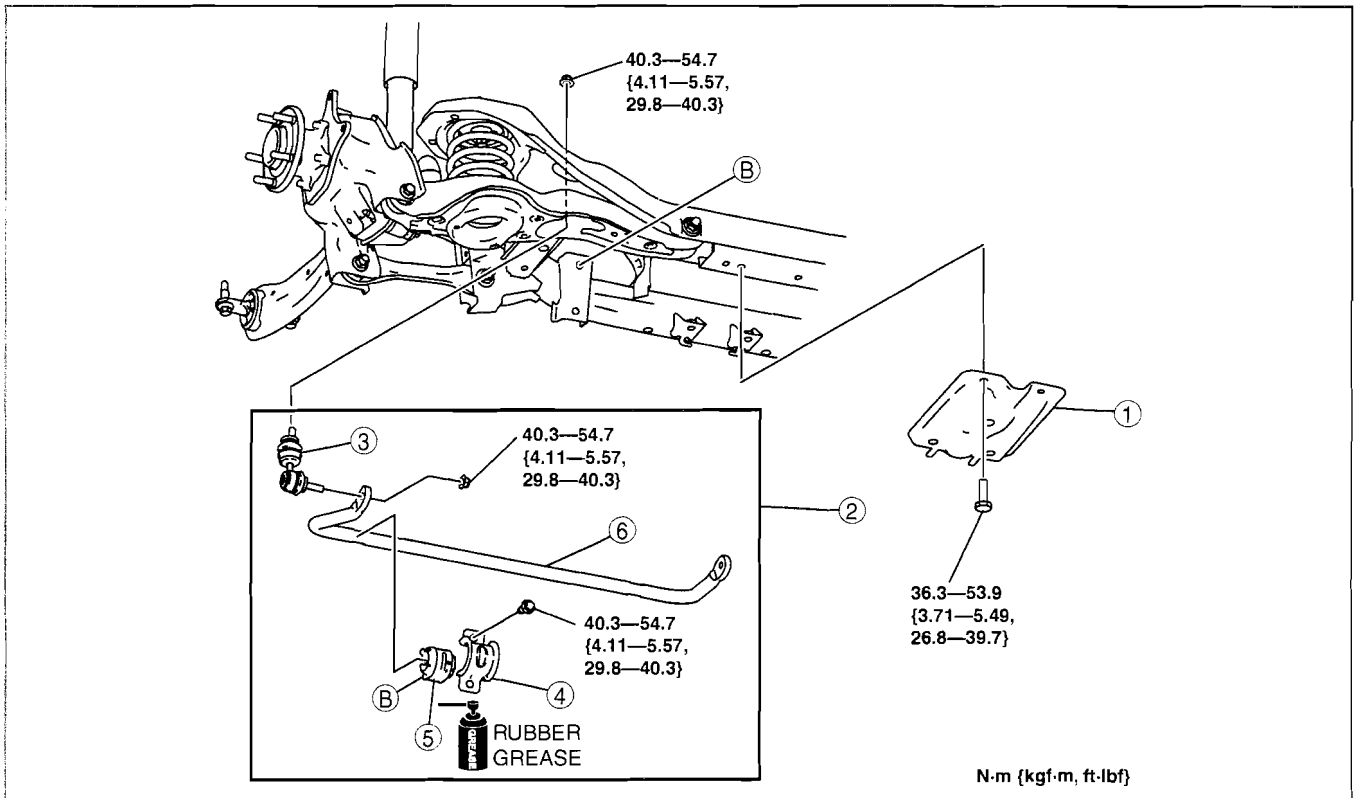

c3u0214w014

1	Rear crossmember bracket
2	Rear stabilizer component (See 02-14-12 Rear Stabilizer Component Installation Note.)
3	Stabilizer control link

4	Stabilizer bracket (See 02-14-10 Stabilizer Bracket Removal Note.) (See 02-14-11 Stabilizer Bracket Installation Note.)
5	Stabilizer bushing (See 02-14-11 Stabilizer Bushing Installation Note.)
6	Rear stabilizer

Stabilizer Bracket Removal Note

1. Secure the stabilizer bracket flange using a vise.
2. Remove the stabilizer bracket.

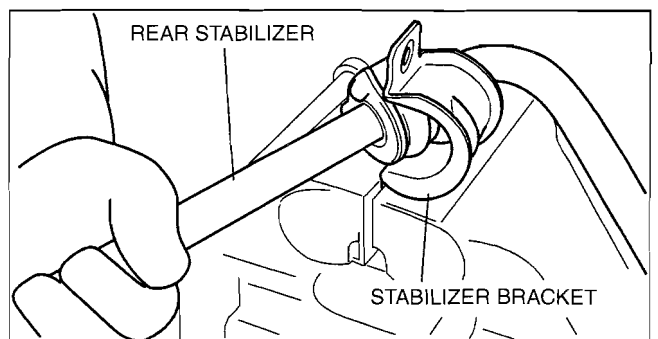

am3uuw0000088

REAR SUSPENSION

Stabilizer Bushing Installation Note

1. Place the stabilizer bushing so that the projection is facing toward the left side of the vehicle.

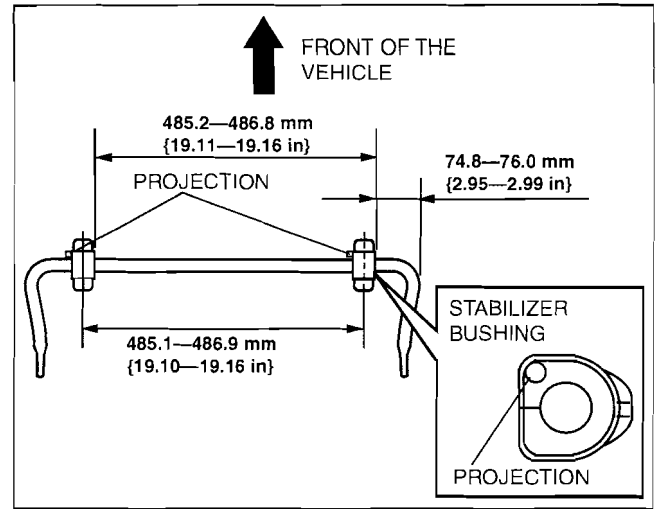

02-14

2. Widen the stabilizer bushing opening **16—26 mm {0.7—1.0 in}** and install the bushing to the rear stabilizer as shown in the figure.

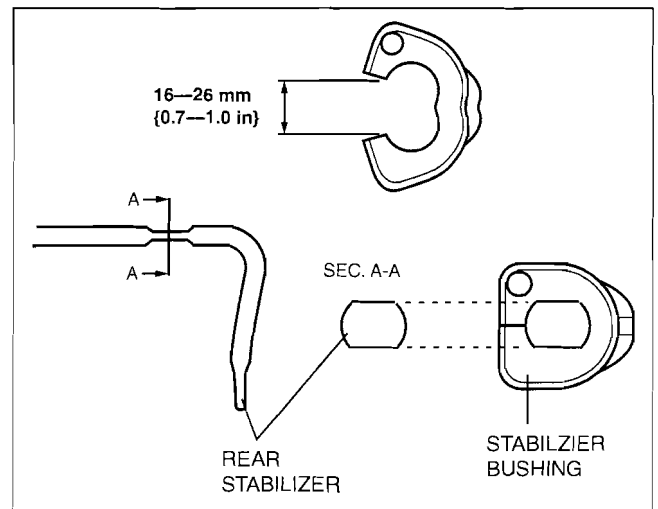

Stabilizer Bracket Installation Note

1. Apply grease to the stabilizer bushing.
2. Install the stabilizer bracket using a vise.

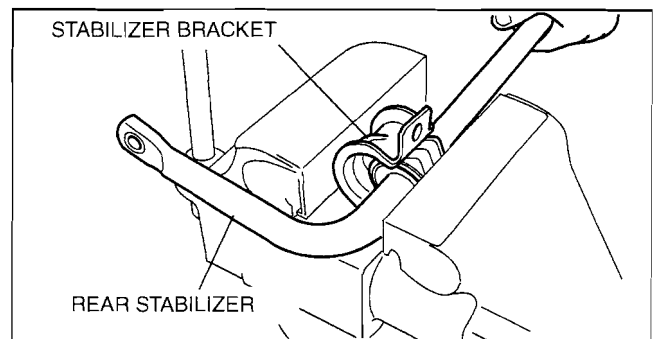

REAR SUSPENSION

Rear Stabilizer Component Installation Note

1. Tighten the bolts in order indicated in the figure.

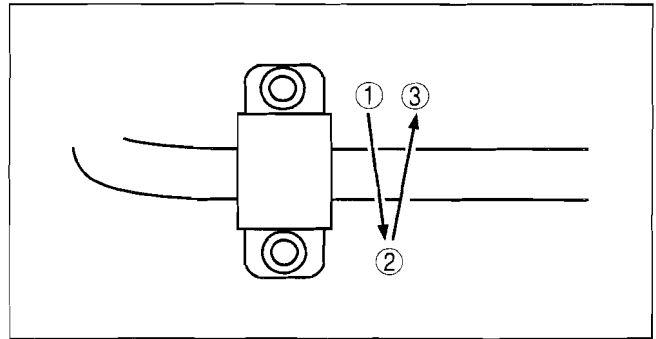

am3uuw000058

STABILIZER CONTROL LINK INSPECTION

id02140080300

1. Remove the stabilizer control link from the vehicle.
2. Inspect for bending or damage. If there is any malfunction, replace the stabilizer control link.
3. Rotate the ball joint stud **10 times** and shake it side to side **10 times**.
4. Measure the ball-joint rotational torque using an Allen wrench and a torque wrench.

Stabilizer control link ball joint rotational torque
0.5—2.0 N·m {6—20 kgf·cm, 5—17 in·lbf}

- If not within the specification, replace the stabilizer control link.

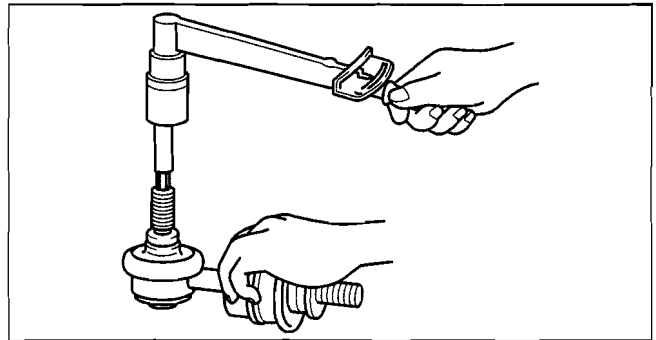

B3E0214W022

REAR CROSSMEMBER REMOVAL/INSTALLATION

id021400801000

Caution

- Performing the following procedures without first removing the ABS wheel-speed sensor may possibly cause an open circuit in the wiring harness if it is pulled by mistake. Before performing the following procedures, disconnect the ABS wheel-speed sensor wiring harness connector (axle side) and fix the wiring harness to an appropriate place where it will not be pulled by mistake while servicing the vehicle.

1. Remove the rear stabilizer. (See 02-14-10 REAR STABILIZER REMOVAL/INSTALLATION.)
2. Remove the charcoal canister. (See 01-16A-7 CHARCOAL CANISTER REMOVAL/INSTALLATION[LF, L3].) (See 01-16B-6 CHARCOAL CANISTER REMOVAL/INSTALLATION[L3 WITH TC].)
3. Remove the evaporative emission (EVAP) system leak detection pump. (See 01-16A-9 EVAPORATIVE EMISSION (EVAP) SYSTEM LEAK DETECTION PUMP REMOVAL/INSTALLATION[LF, L3].) (See 01-16B-7 EVAPORATIVE EMISSION (EVAP) SYSTEM LEAK DETECTION PUMP REMOVAL/INSTALLATION[L3 WITH TC].)
4. Remove in the order indicated in the table.
5. Install in the reverse order of removal.
6. Inspect the wheel alignment and adjust it if necessary. (See 02-11-4 REAR WHEEL ALIGNMENT.)

REAR SUSPENSION

02-14

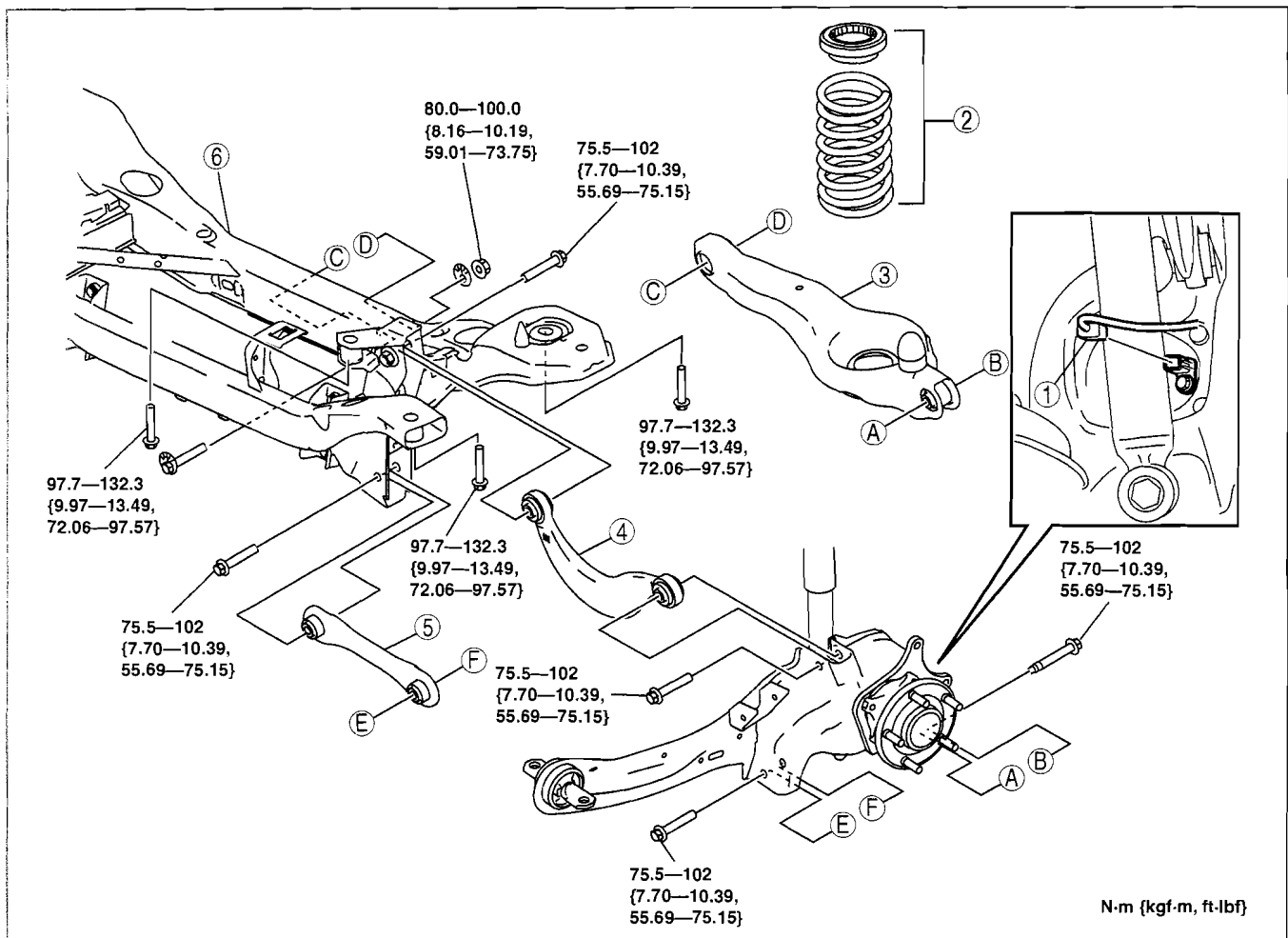

1	ABS wheel-speed sensor wiring harness connector
2	Rear coil spring (See 02-14-4 REAR COIL SPRING REMOVAL/INSTALLATION.)
3	Rear lower arm (See 02-14-5 REAR LOWER ARM REMOVAL/INSTALLATION.)

4	Rear upper arm (See 02-14-7 REAR UPPER ARM REMOVAL/INSTALLATION.)
5	Rear lateral link (See 02-14-6 REAR LATERAL LINK REMOVAL/INSTALLATION.)
6	Rear crossmember (See 02-14-13 Rear Crossmember Removal Note.)

Rear Crossmember Removal Note

Warning

- Verify that the crossmember is securely supported by a jack. If the rear crossmember falls off, it can cause serious injury or death, and damage to the vehicle.

1. Support the rear crossmember with the jack and remove the bolt.
2. Remove the rear crossmember.

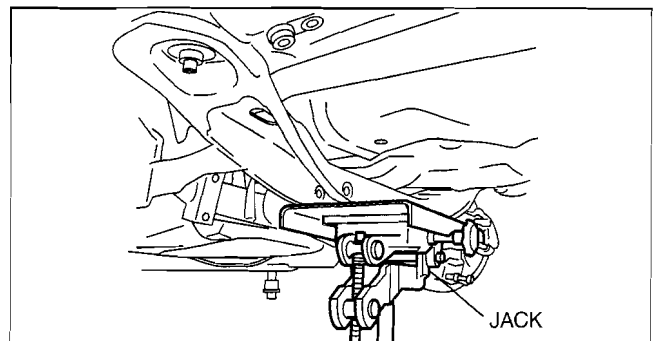

am3uuw0000089

