

[< Previous](#) [Next >](#)

2012 - Mazda5 - Body and Accessories

RAIN SENSOR REMOVAL/INSTALLATION

1. Disconnect the negative battery cable.
2. Compress the rain sensor cover as shown in the figure.

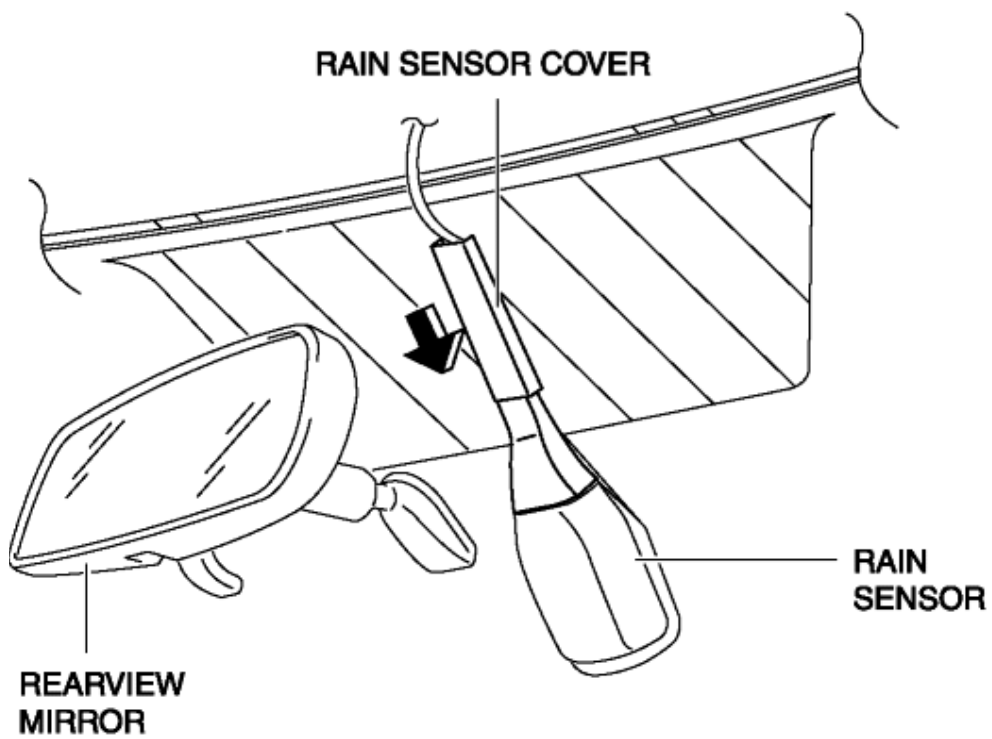
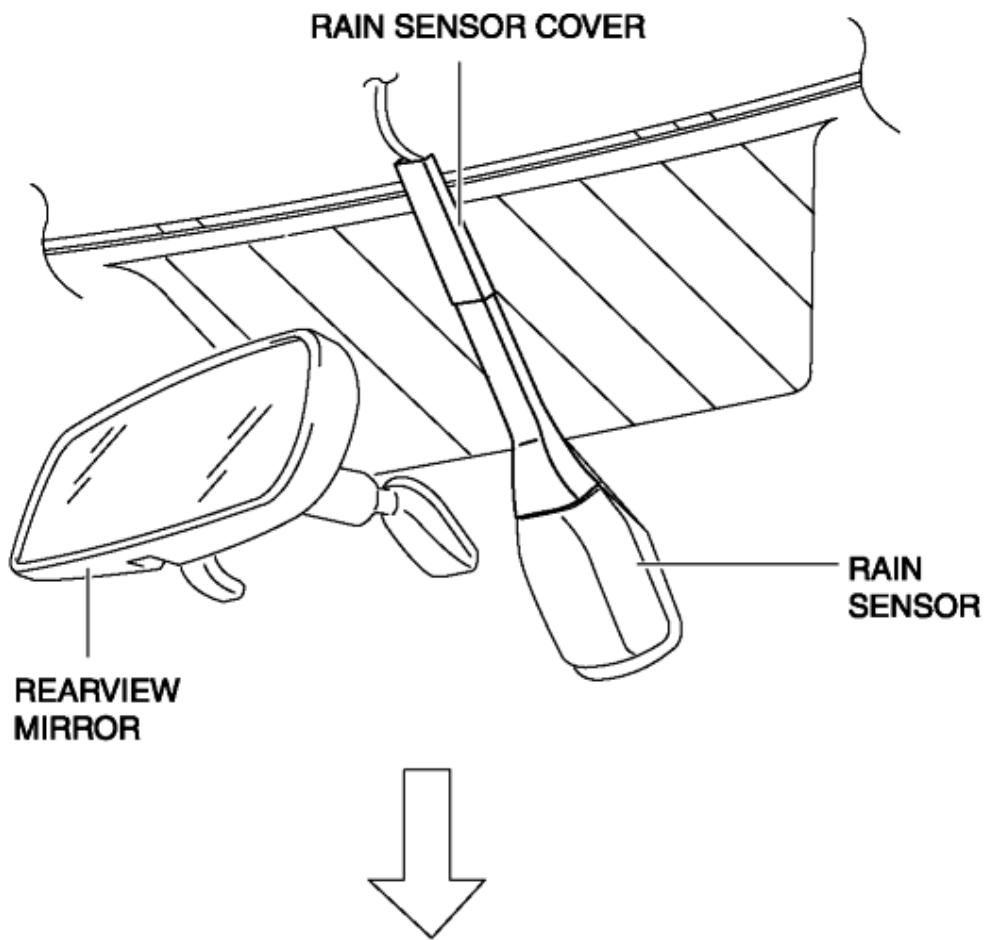

3. Slide tabs B in the direction of the arrow to disengage the tabs.



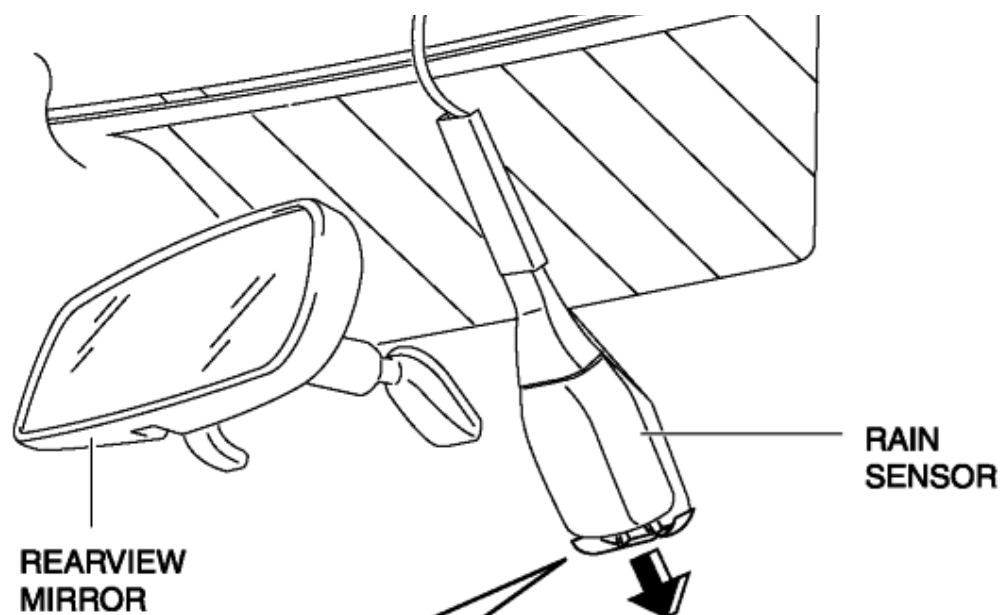

RIGHT-SIDE

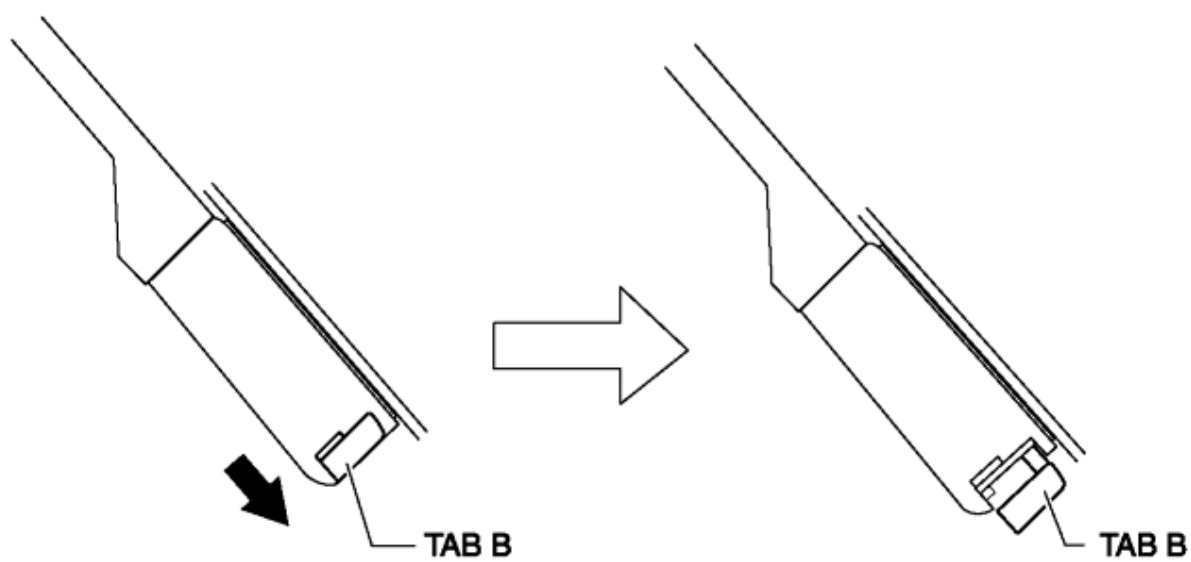

LEFT-SIDE

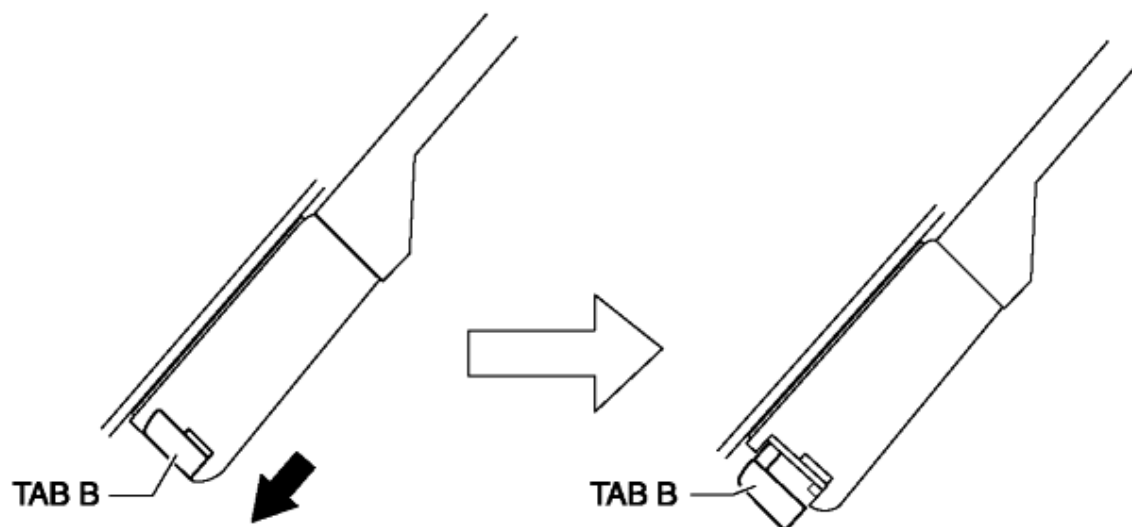

4. Remove the rain sensor in the direction of the arrow shown in the figure.

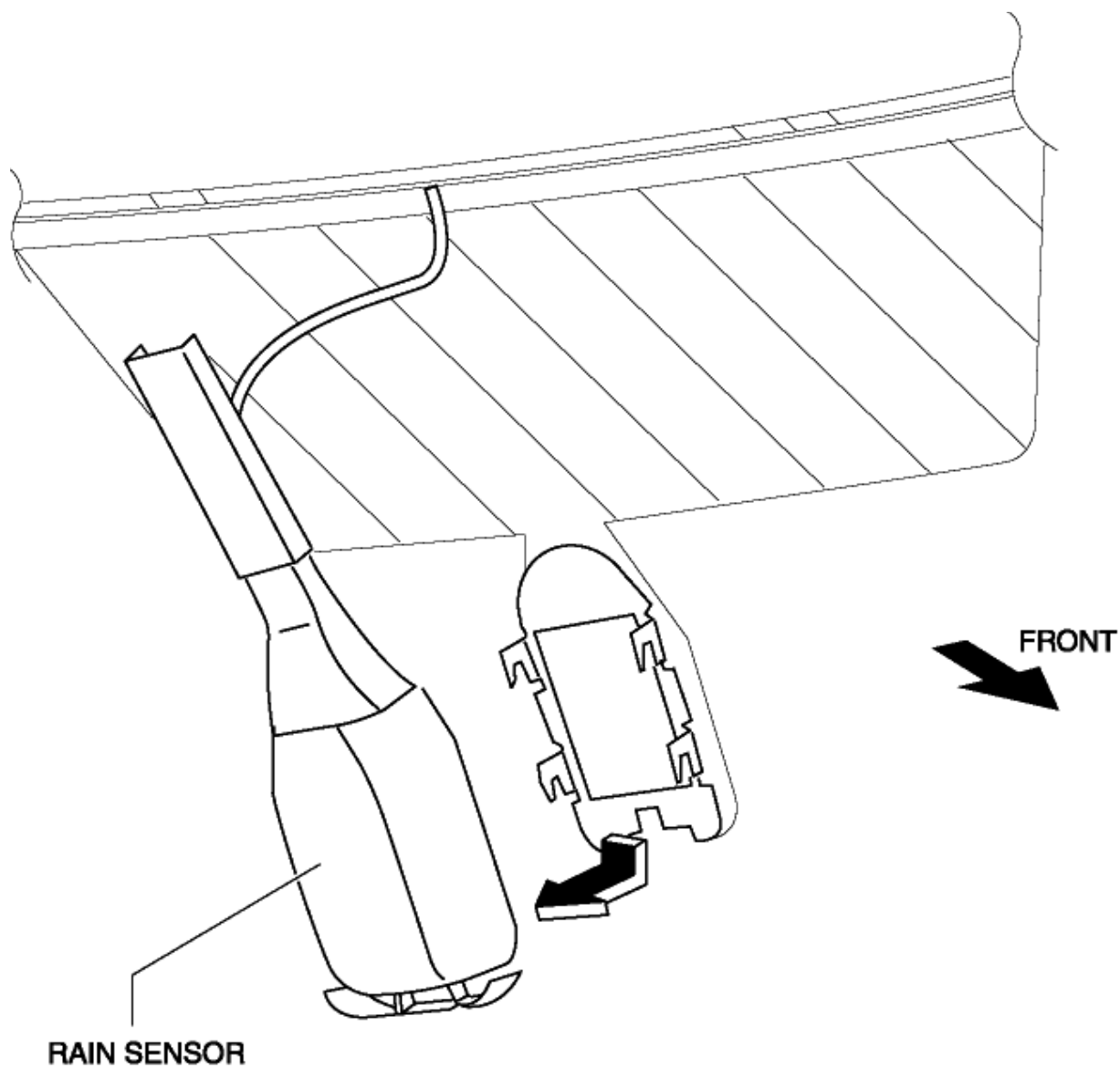

5. Remove the rain sensor cover in the direction of the arrow shown in the figure.

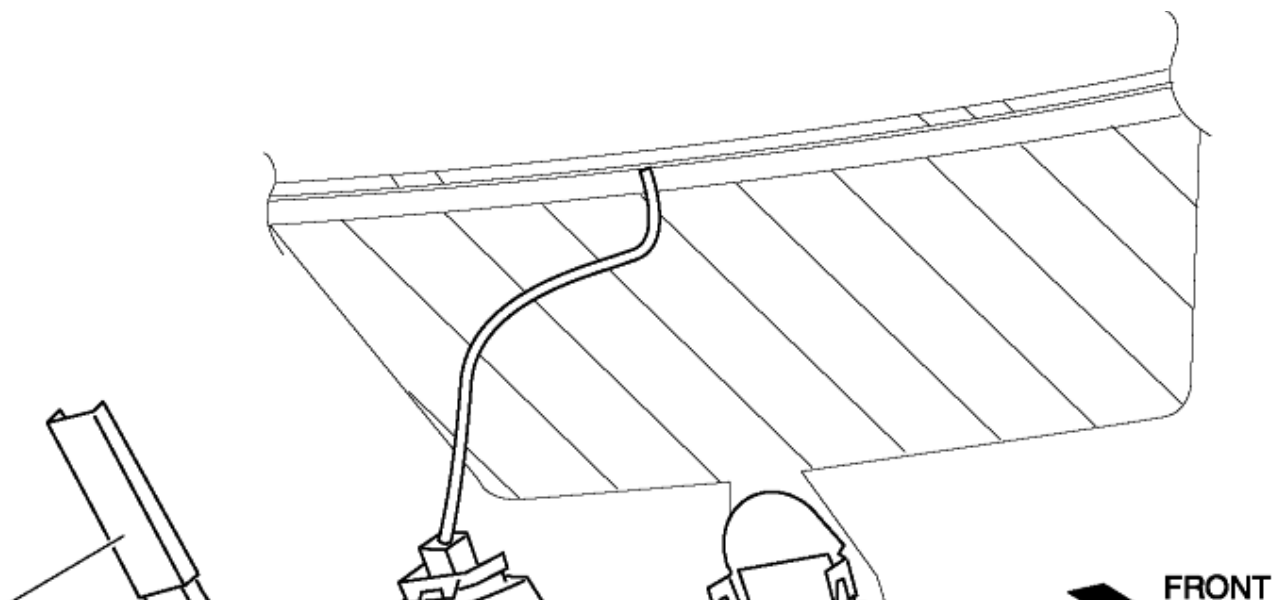

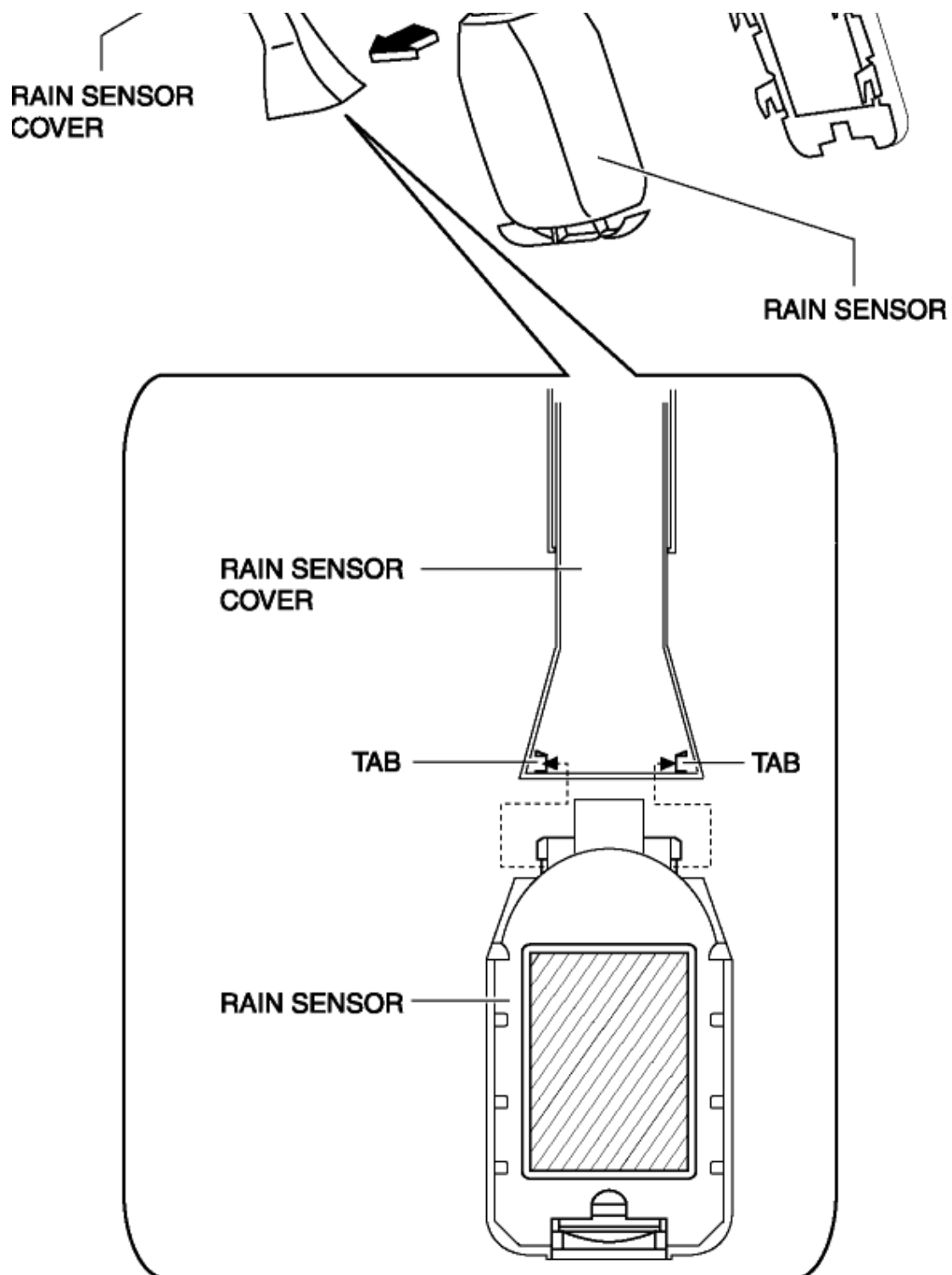

6. Disconnect the rain sensor connector.

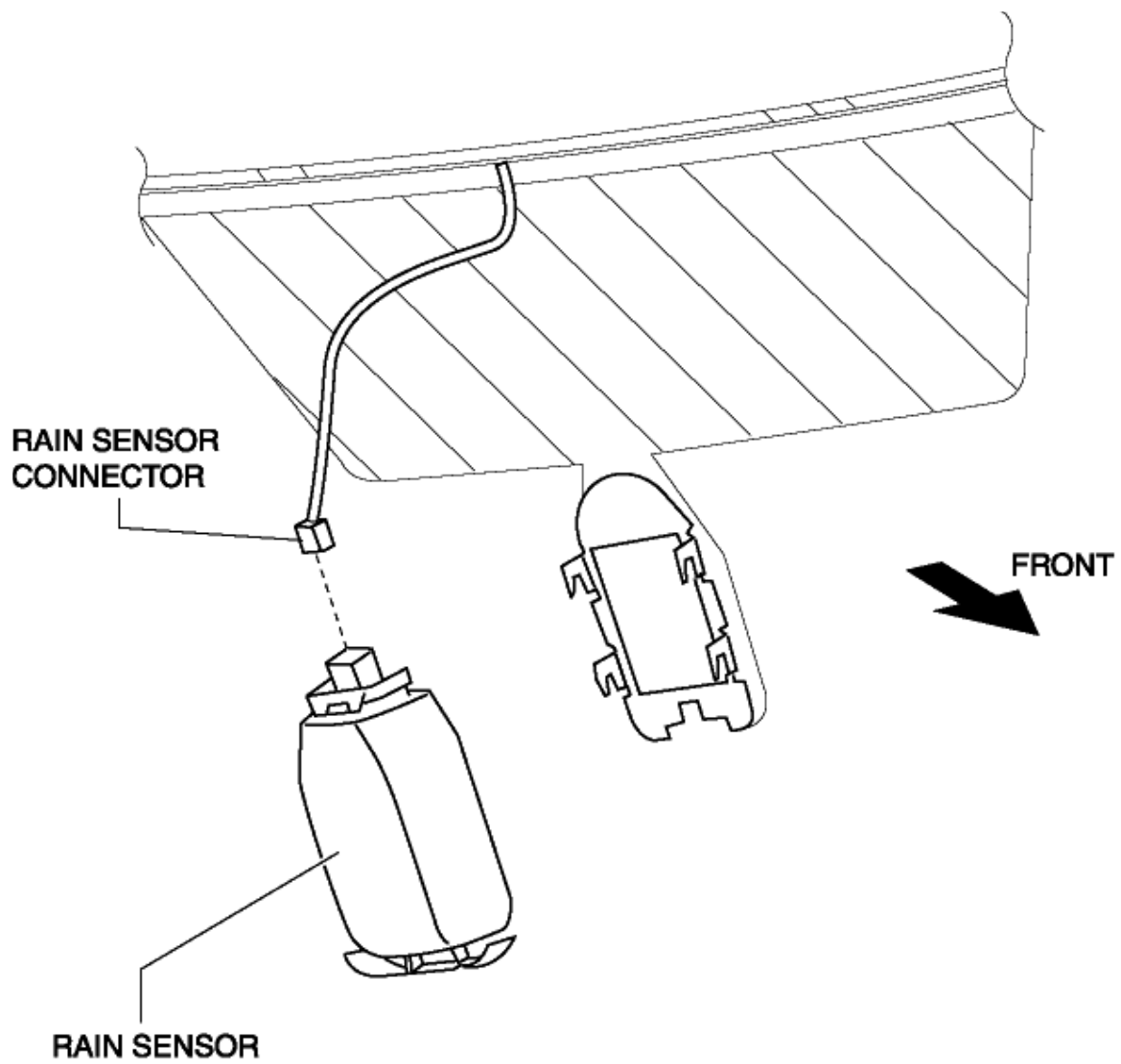

7. Install in the reverse order of removal.

[< Previous](#) [Next >](#)

© 2011

[Back to Top](#)