

CAR-NAVIGATION UNIT CONSTRUCTION

B3E092066902T02

Structure

- The car-navigation unit is located in the glove compartment.
- An eject button, to eject the DVD-ROM from the loading slot, is included in the unit.
- A gyro sensor which detects vehicle cornering angle is built into the unit.

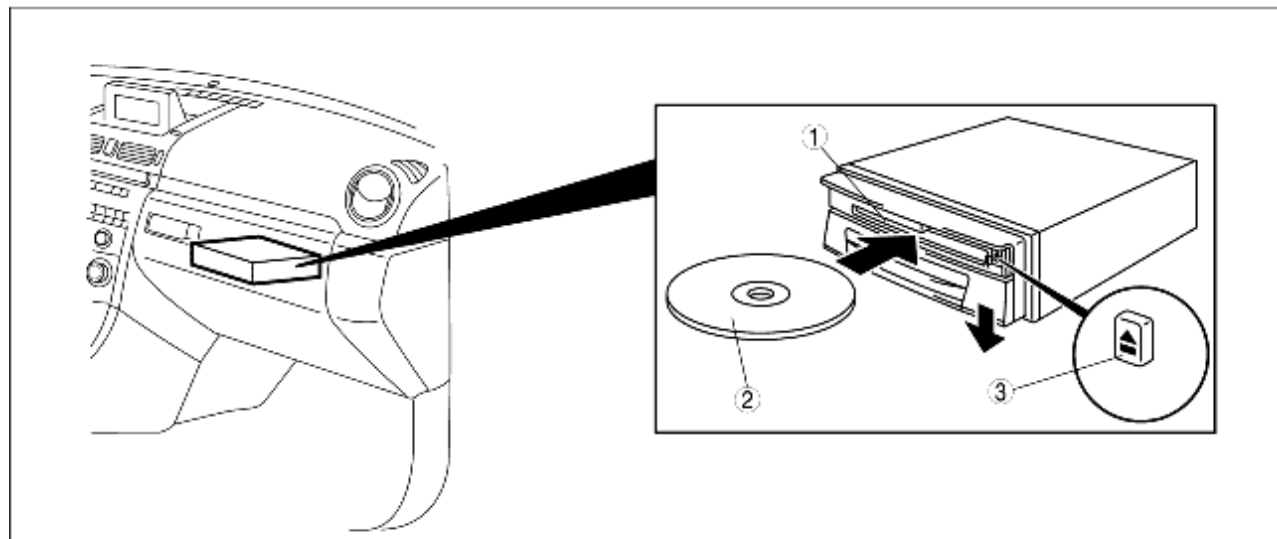

B3E0920T103

1	DVD-ROM loading slot
2	DVD-ROM
3	Eject button

Terminal Layout and Signals

Terminal	Signals
	16-pin connector
	1A GND
	1B B+
	1C -
	1D ACC
	1E PR front speaker input (-)
	1F Illumination (-)
	1G PR front speaker input (+)
	1H Vehicle speed
	1I PR front speaker output (-)
	1J Parking brake switch
	1K PR front speaker output (+)
	1L R-range
	1M Front speaker output (-)
	1N Front speaker output (+)

1O	Front speaker input (-)
1P	Front speaker input (+)

Terminal	Signals	
	24-pin connector	
	2A	-
	2B	-
	2C	-
	2D	-
	2E	-
	2F	-
	2G	-
	2H	-
	2I	-
	2J	-
	2K	-
	2L	-
	2M	-
	2N	Monitor serial input
	2O	Shield GND
	2P	Monitor serial output
	2Q	Shield GND
	2R	Video (composite sync)
	2S	-
	2T	Video (B)
	2U	Video GND
	2V	Video (G)
	2W	-
	2X	Video (R)

Terminal	Signals	
	8-pin connector (for extended function)	
	3A	-
	3B	Serial output
	3C	-
	3D	Serial input
	3E	Power
	3F	Reset
	3G	B+
	3H	GND

Terminal	Signal	
	1-pin connector	
	4A	GPS antenna input

CAR-NAVIGATION CONTROL SWITCH CONSTRUCTION/OPERATION

B3E092066921T02

Construction

- The car-navigation control switch is located on the console.

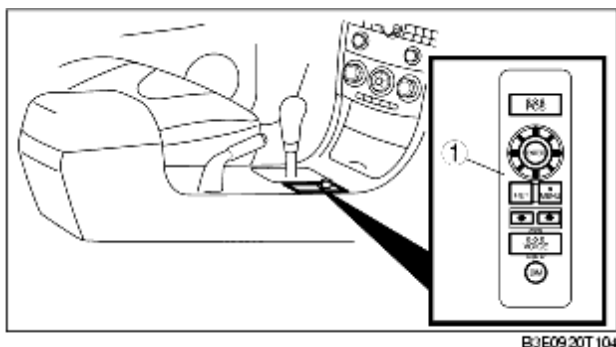

1 Car-navigation control switch

Terminal layout and signal

Terminal	Signal
	A -
	B -
	C -
	D -
	E -
	F -
	G B+
	H Ground
	I Illumination (+)
	J -
	K Remote-data
	L Shield ground
	M -
	N -
	O -
	P -

Operation