



Your Vehicle: 2009 Mazda 5 L4-2.3L

Vehicle » Brakes and Traction Control » Brake Pedal Assy » Service and Repair

Service and Repair

BRAKE PEDAL REMOVAL/INSTALLATION

CAUTION:

- The clearance between the brake switch and the brake pedal is automatically adjusted to the correct amount when the brake switch is inserted into the installation hole on the brake pedal and rotated to fix in place. If the brake switch is not properly installed, the clearance may be incorrect, causing a brake light malfunction. Therefore, always verify that the brake pedal is properly installed and fully released before installing the brake switch to the pedal.
 - Once the brake switch clearance has automatically been adjusted, it cannot be adjusted again. Therefore, replace the switch with a new one when replacing the power brake unit or the pedal, or performing any procedure that changes the pedal stroke.
1. Remove the battery and battery tray. [See: Starting and Charging\Battery\Service and Repair\Removal and Replacement](#)
 2. Disconnect the brake pipe (master cylinder side). [See: Hydraulic System\Brake Master Cylinder\Service and Repair](#)
 3. Disconnect the reserve hose (master cylinder side). (MTX) [See: Hydraulic System\Brake Master Cylinder\Service and Repair](#)
 4. Remove the column cover (under side). (See [See: Steering and Suspension\Steering\Steering Column Cover\Service and Repair](#))
 5. Remove the accelerator pedal. [See: Powertrain Management\Fuel Delivery and Air Induction\Accelerator Pedal\Service and Repair](#)
 6. Remove in the order indicated in the table.
 7. Install in the reverse order of removal.
 8. After installation, add [brake fluid](#), bleed the air, and inspect for fluid leakage. [See: Brake Bleeding\Service and Repair](#)

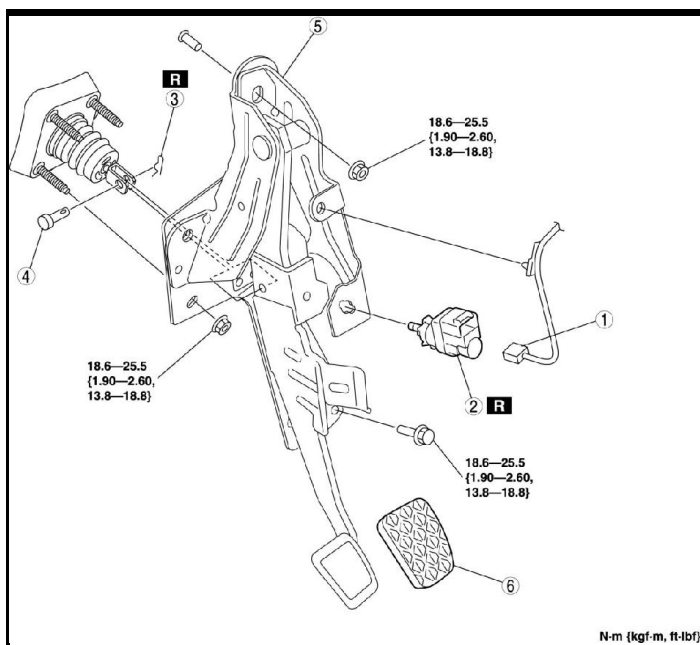

1	Brake switch connector
2	Brake switch (See Brake Switch Installation Note.)
3	Spring pin
4	Clevis pin

	(See Brake Switch Installation Note.)
3	Spring pin
4	Clevis pin
5	Brake pedal
	(See Brake Pedal Removal Note.)
6	Pedal pad

Brake Pedal Removal Note

1. Move the power brake unit to the vehicle front where the power brake unit fork does not interfere with the brake pedal arm.
2. Remove the brake pedal.

Brake Switch Installation Note

1. Inspect the brake pedal. [See: Testing and Inspection](#)
2. With the brake pedal fully released, insert a new brake switch into the installation hole on the brake pedal.
3. Secure the brake switch by turning it counterclockwise 45° .

