

Service Information

Mazda Motor Corporation

3-1, Shinchi, Fuchu-cho, Aki-gun
Hiroshima 730-8670, Japan
TEL : 81(82)287-5323
FAX : 81(82)287-5220



Category T	Repair Guidance	Ref. No. R027/18A	Page 1 of 4
Coverage <input type="checkbox"/> Distributor only <input checked="" type="checkbox"/> Please inform your dealers		Date Issued May 15, 2018	
Please convey this information to your <input type="checkbox"/> Director <input checked="" type="checkbox"/> General Manager <input checked="" type="checkbox"/> Warranty Dept. <input checked="" type="checkbox"/> Parts Dept. <input checked="" type="checkbox"/> Training Dept. <input checked="" type="checkbox"/> Field Rep.		Date Revised July 13, 2018	
Applicable Model CX-5 (KF)		Applicable Countries and/or Vehicle Specifications Worldwide	

REVISED

Revision Note: Warranty information has been revised.

Subject: Foggy Lens of Rear Combination Lights

DESCRIPTION

Some customers may complain about the lens of the rear combination lights being foggy after carwash or heavy rain etc.

CAUSE

Water may enter into the rear combination lights from the ventilation tube under certain conditions.

MASS PRODUCTION CHANGE

The ventilation tube has been changed to ventilation cap to prevent water entry.

SUBJECT VIN & PRODUCTION DATE RANGE

CX-5(KF) / (KE with VIN 600001~ for Russia)

Japan Built

Spec.	VIN Range		Production Date Range
Europe (L.H.D. & UK Specs.)	JMZ KF**** **	600052 - 690415	Feb. 14, 2017 - Feb. 6, 2018
Russia	JMZ KE**** **	600052 - 690417	Feb. 14, 2017- Feb. 6, 2018

REPAIR PROCEDURE

NOTE: Ensure to repair both rear combination lights units even though one of the rear combination lights units is not foggy.

1. Confirm if the condensation is running down.
IF YES, replace the whole rear combination lights unit according to the workshop manual "REAR COMBINATION LIGHT REMOVAL/INSTALLATION".
IF NOT, go to next step.



Need to replace the unit



NO need to replace the unit

2. Remove the rear combination lights unit.
3. Remove the ventilation tube at the backside of the lights.

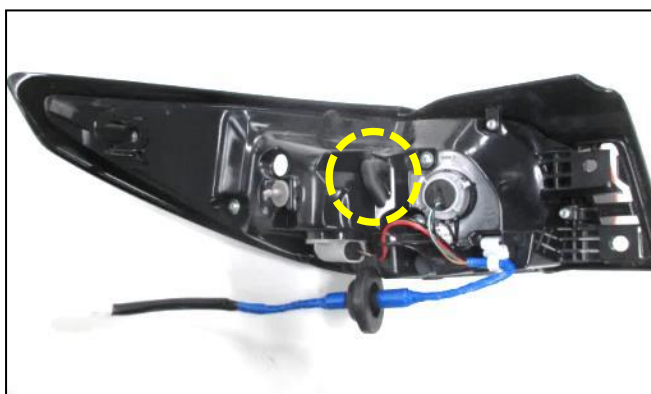

RIGHT



LEFT

NOTE: ~~ValveBulb~~ type rear combination lights has two ventilation tubes. The tube to be removed is only the inner one (1). Do not remove (2).

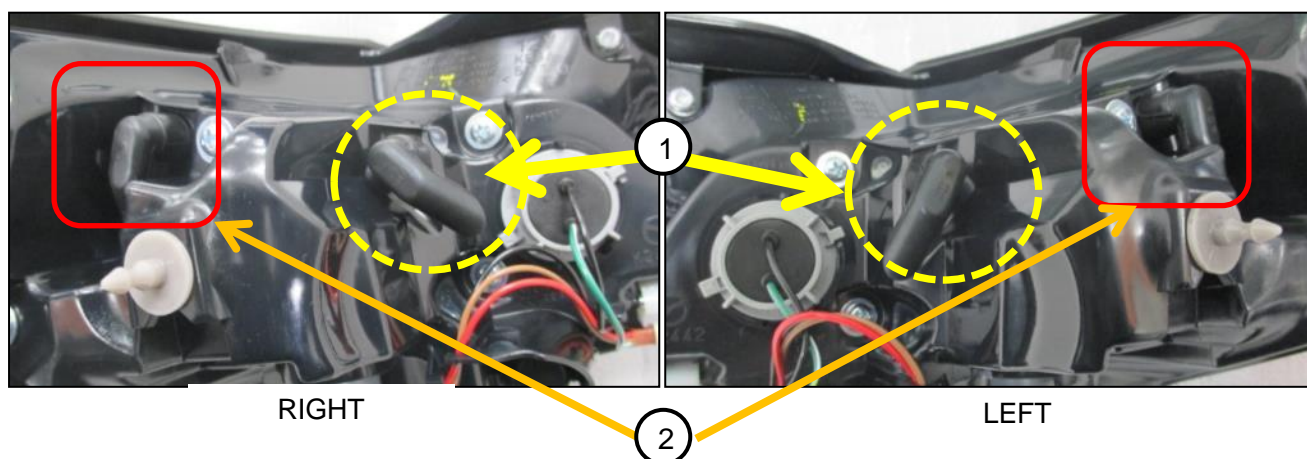

RIGHT

LEFT

4. Remove the turn light bulb socket.
NOTE: Pay attention not to hit the bulb.



5. Insert the dryer to the turn light bulb socket hole and blow **cold air** for 20min. (Blow cold air for 1min to ventilate inside when you repair the lights unit which is not foggy.)
NOTE: DO NOT blow warm air since it may cause part deformation.



6. Install the turn light bulb socket.
7. Install the ventilation cap to the rear combination lights instead of the ventilation tubes.
NOTE: Push the cap cover in parallel with the flange at the rear combination light housing. Ensure to push it to the 2mm away from the flange at the rear combination light housing. If you push it stronger, it may cause reoccurrence of the problem.

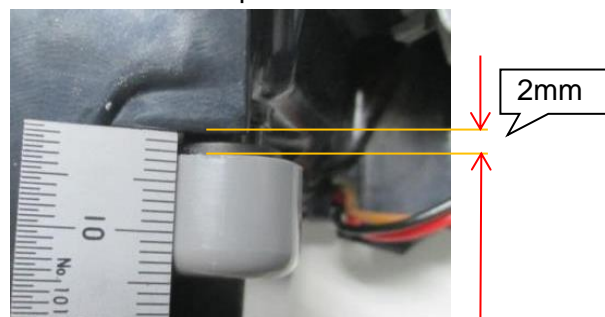

View from the top

8. Install the rear combination lights unit.
9. Repair the other rear combination lights unit according to the above procedure.

PARTS INFORMATION

Part Number (NEW)	Part Number (OLD)	Description	Qty	Remark
K123-51-160H	K123-51-160G	LIGHTS(L),RR COMB	1	Europe, General, China, Australia specs.
K123-51-150H	K123-51-150G	LIGHTS(R),RR COMB	1	Europe, General, China, Australia specs.
KB8M-51-160G	KB8M-51-160F	LIGHTS(L),RR COMB	1	Europe, General, China, Australia specs.
KB8M-51-150G	KB8M-51-150F	LIGHTS(R),RR COMB	1	Europe, General, China, Australia specs.
K1Y3-51-516	-	VENTILATION CAP	1	Includes two caps

NOTE: Check EPC and select appropriate part when you order the rear combination lights.

WARRANTY INFORMATION

Assembly group	S - Body
Subassembly group	77 - WATER INGRESS
Symptom Code	79 (Condensation)
Damage Code	99
Causal Part No.	****-51-160*/****-51-150* (Select the part number of rear combination lights applicable to the subject vehicle from "Parts Information" and enter it.)
Quantity	0 or 1
Operation No. and Labor Hours	Refer to the tables below.
Period Covered	Normal Warranty Period
Prior approval necessary	NO

Without i-stop

Performed repair		Operation No	Labor hours
Unit replacement	Cap installation		
0 unit	2 units	XXP48ARX	0.4H
1 unit	1 unit	XXP48BRX	0.3H
2 units	0 unit	XXP48CRX	0.3H

With i-stop

Performed repair		Operation No	Labor hours
Unit replacement	Cap installation		
0 unit	2 units	XXP48DRX	0.4H
1 unit	1 unit	XXP48ERX	0.4H
2 units	0 unit	XXP48FRX	0.4H

Kimiaki Inooka
Manager, Technical Information Group
Technical Service Department
Mazda Motor Corporation
2HA2621713, 152-155(MC Internal Use)