

ELECTRIC PARKING BRAKE MOTOR GEAR UNIT

id041200300400

Purpose/Function

- The electric parking brake motor unit operates the built-in motor to press out the disc pads using the torque increased by the gear reduction to maintain the rear disc plate in a clamped condition. When the electric parking brake is released, the motor rotates in the opposite direction.

Construction

- The electric parking brake motor gear unit is located on the rear brake caliper.

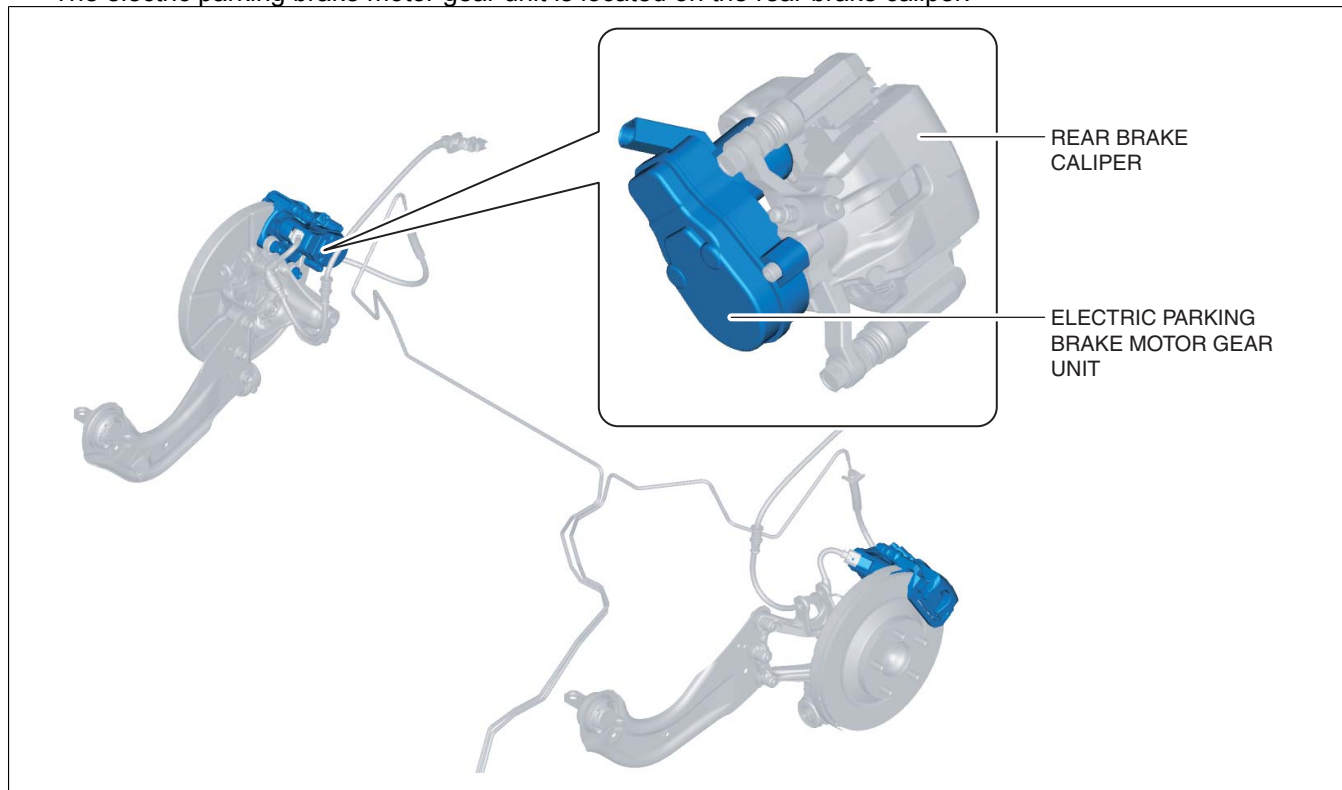

ac5wzn00003525

- The electric parking brake motor gear unit is built into the motor and the planetary gear.

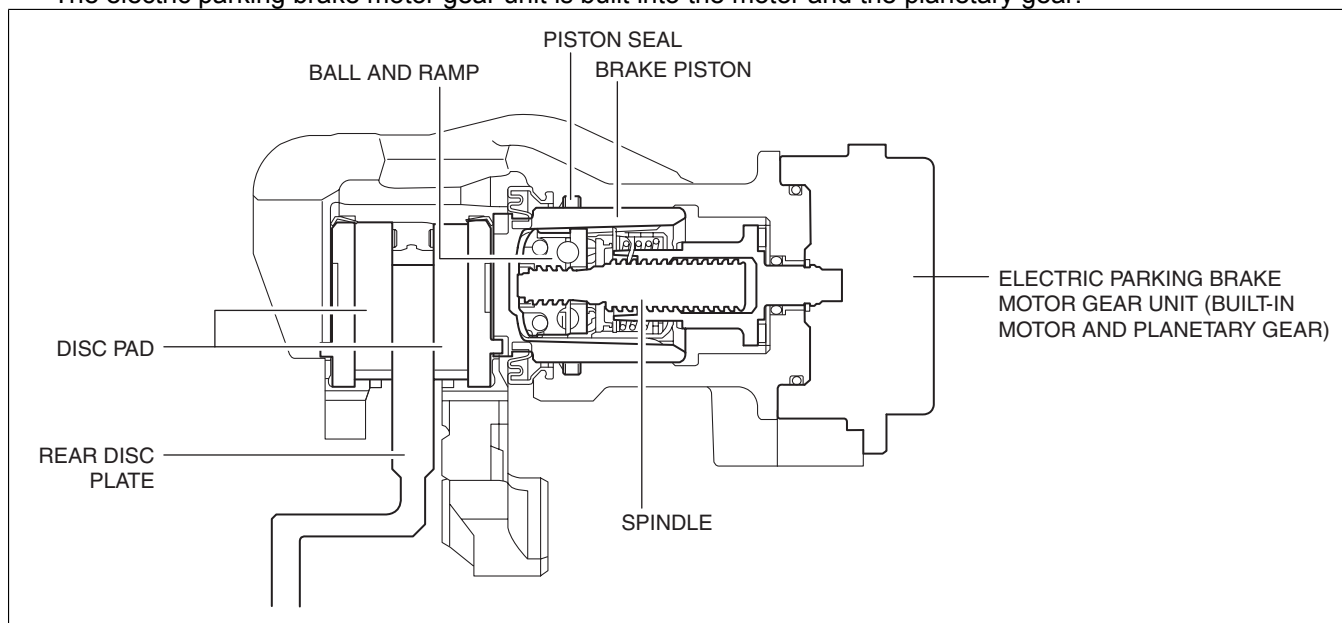

ac5wzn00003526

Operation

When operating electric parking brake

1. When motor operation current flows from the electric parking brake control module, the electric parking brake motor gear unit operates the built-in motor.

2. The motor speed/torque is transmitted to the spindle by decelerating the speed using the built-in planetary gear and increasing the torque.

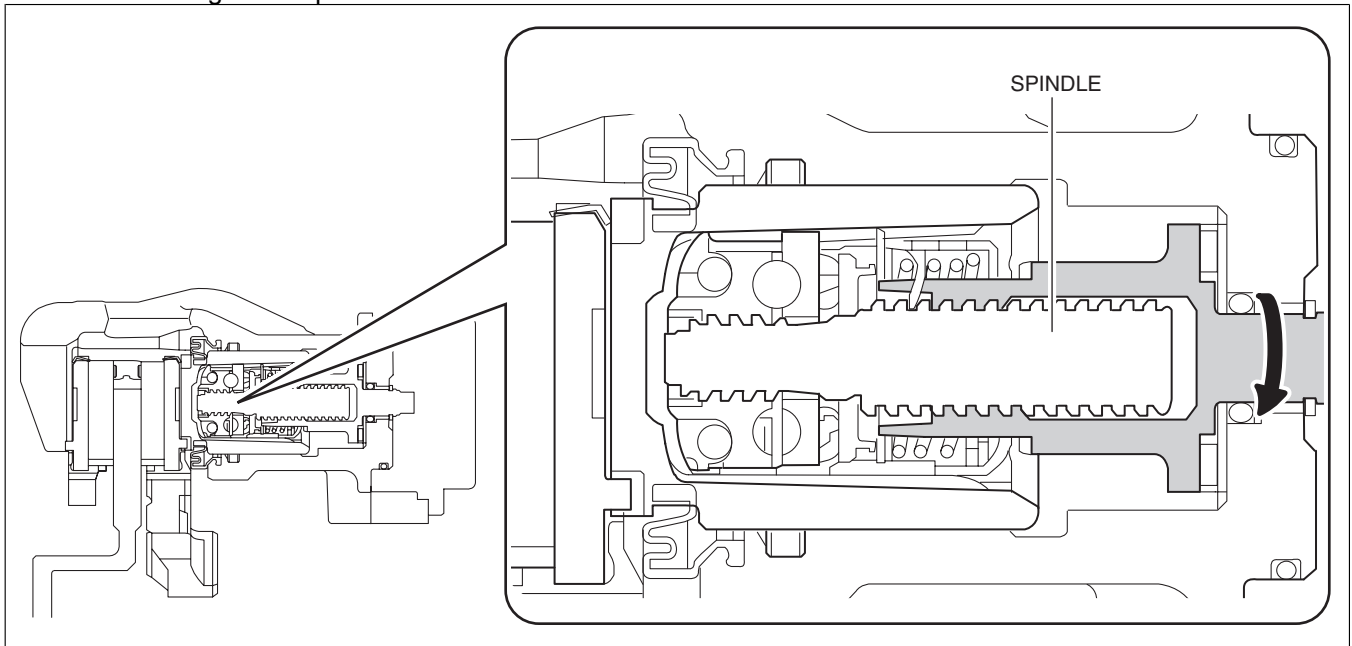

ac5wzn00003527

3. When the spindle rotates, the ball and ramp moves to the brake piston side and it contacts the brake piston.

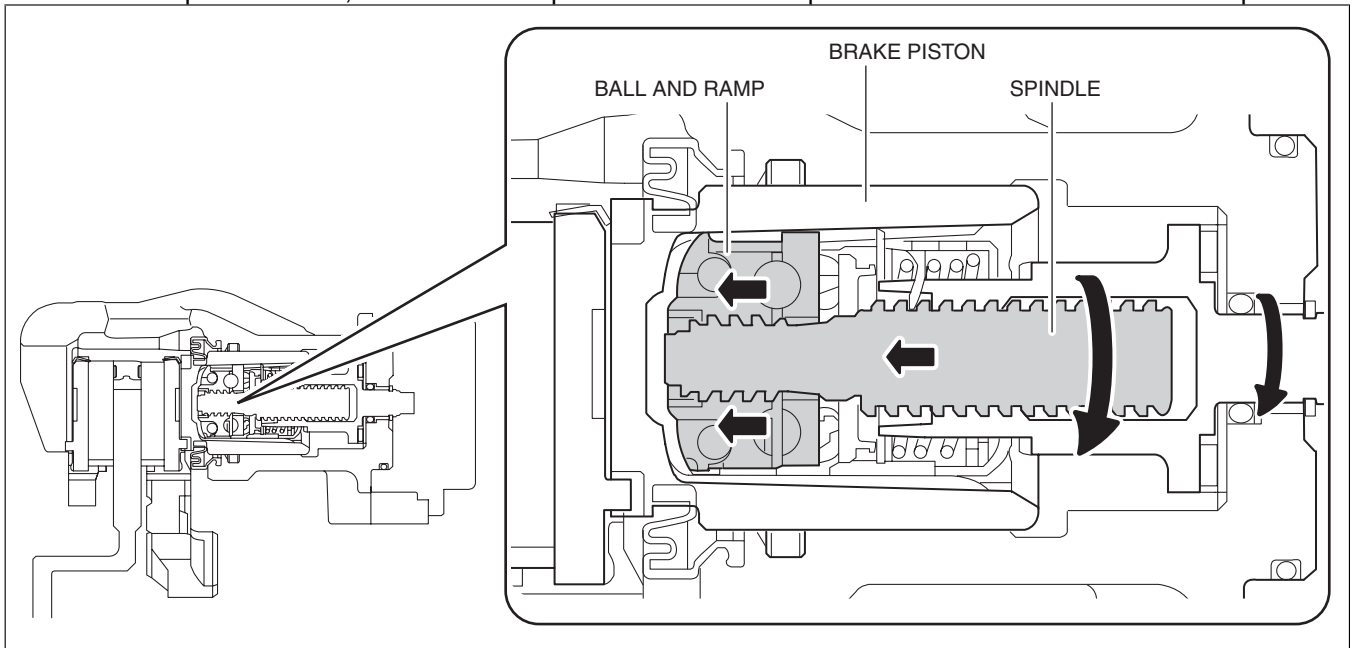

ac5wzn00003528

4. The contacted ball and ramp moves the brake piston to the disc pad side and the brake piston is pressed against the disc pad.

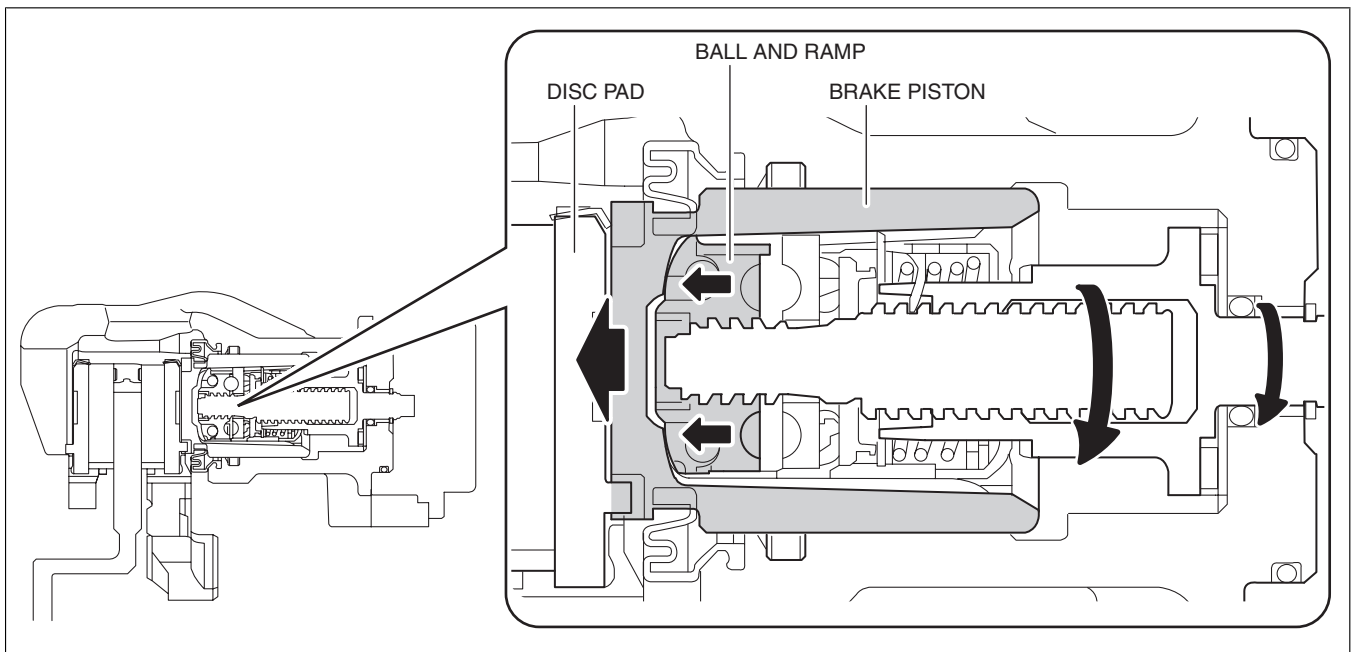

ac5wzn00003529

5. The disc pads are pressed against the rear disc plate and the rear disc plate is held engaged.

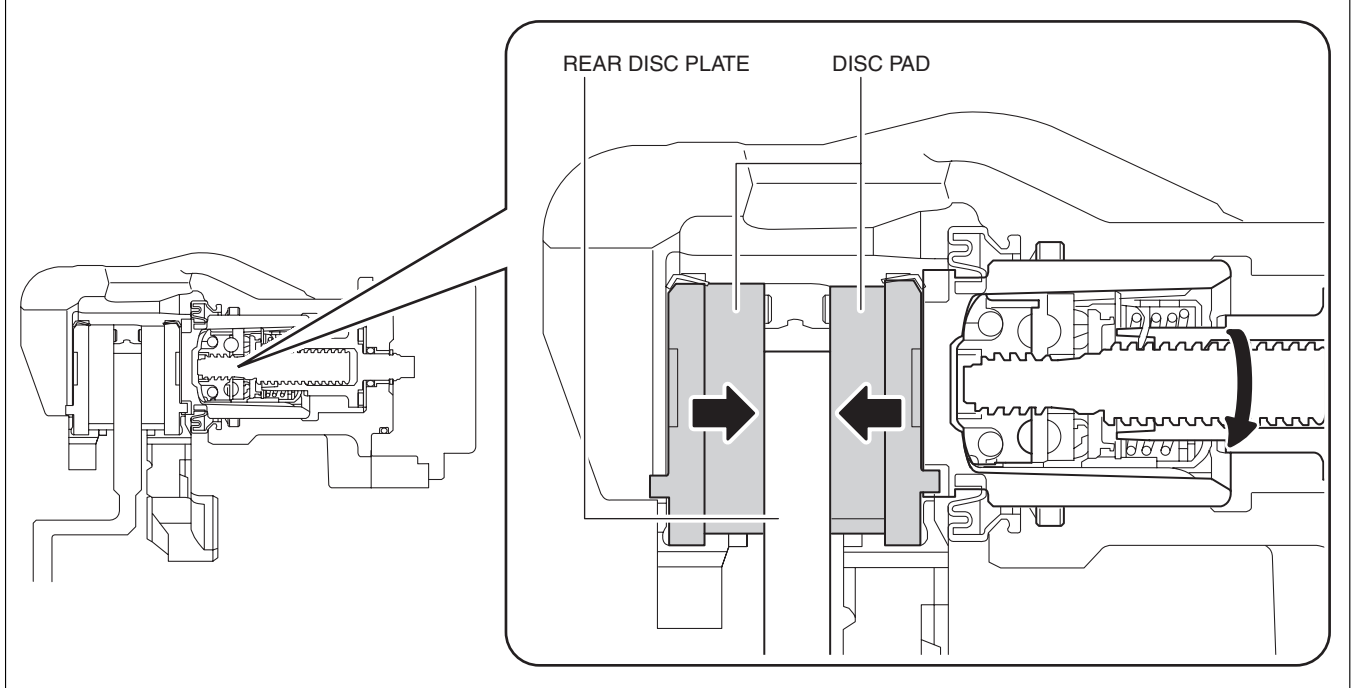

ac5wzn00003530

When releasing electric parking brake

1. When motor operation current flows from the electric parking brake control module, the electric parking brake motor gear unit operates the built-in motor.
2. The motor rotates in the opposite direction of the electric parking brake operation.
3. The motor speed/torque is transmitted to the spindle by decelerating the speed using the built-in planetary gear and increasing the torque.

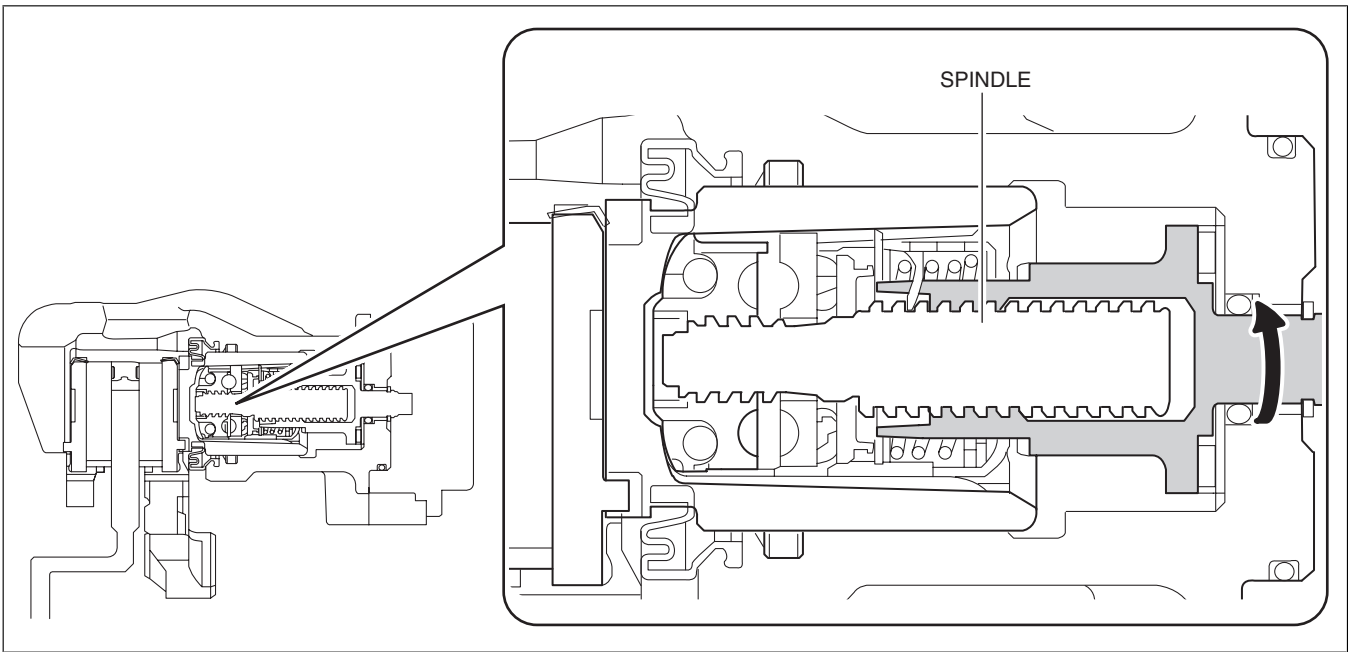

ac5wzn00003531

4. When the spindle rotates, the ball and ramp moves to the motor side and separates from the brake piston.

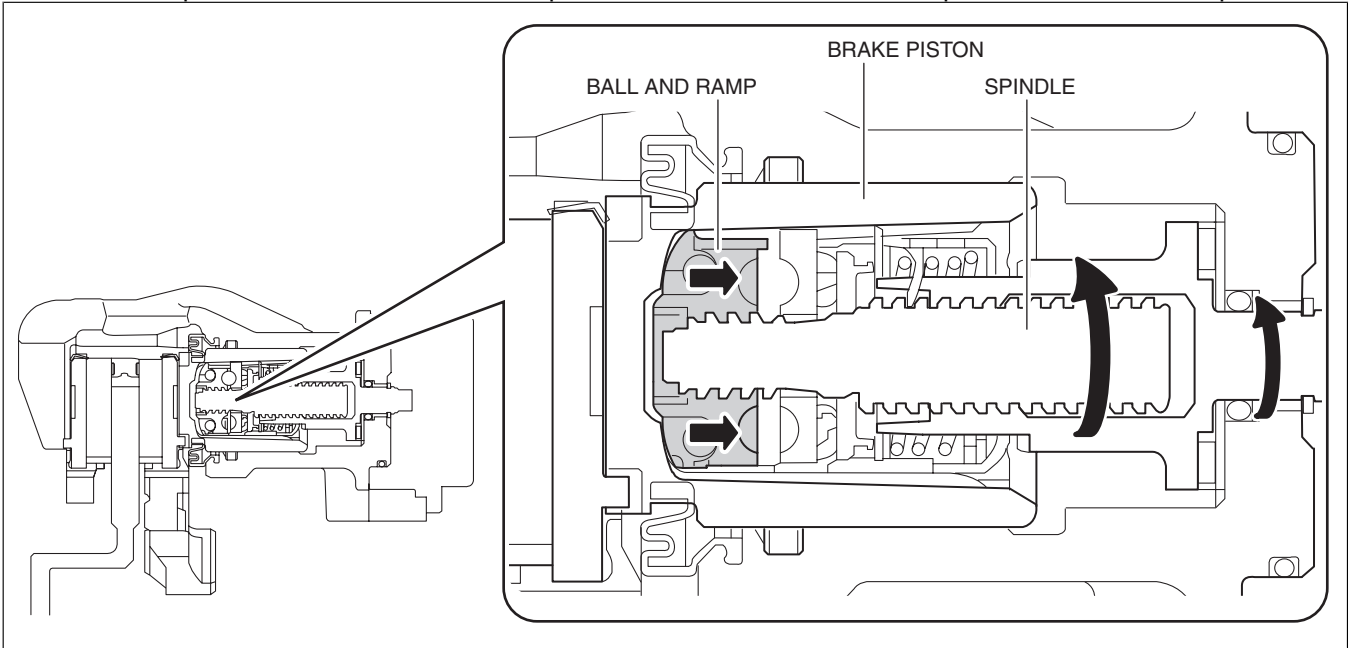

ac5wzn00003532

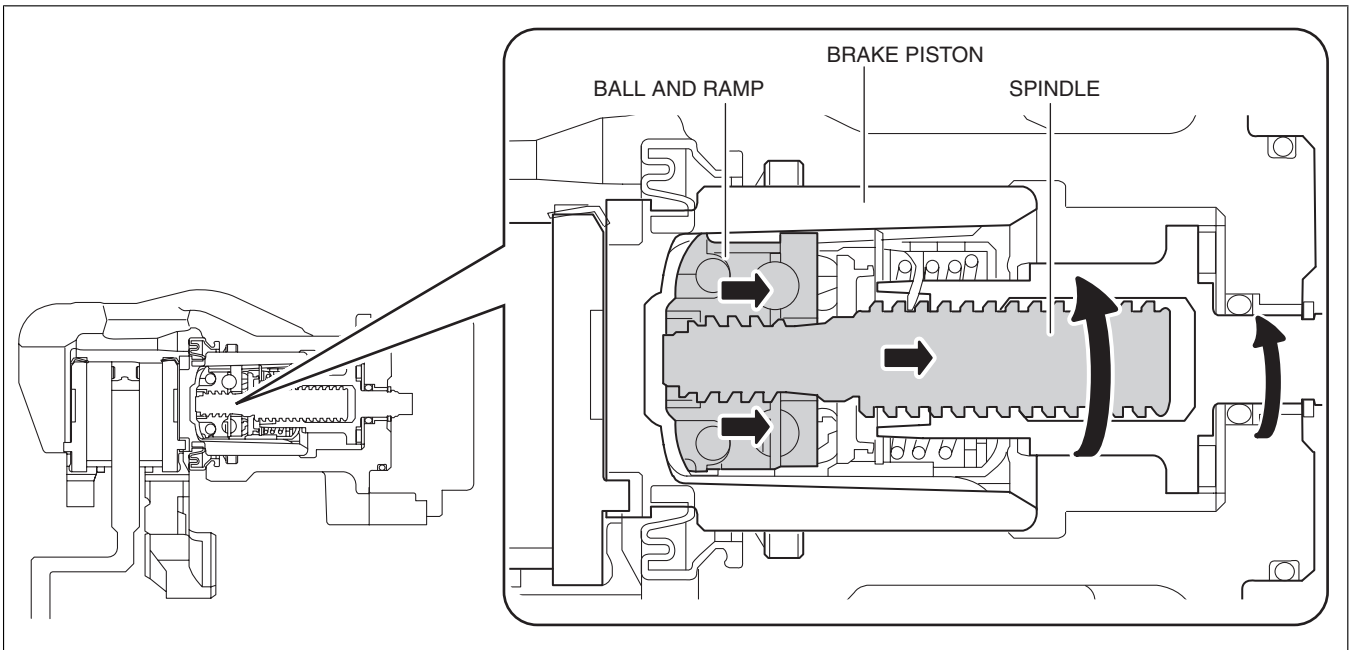

ac5wzn00003533

5. The brake piston separates from the disc pad by the piston seal force to release the engaged the rear disc plate.

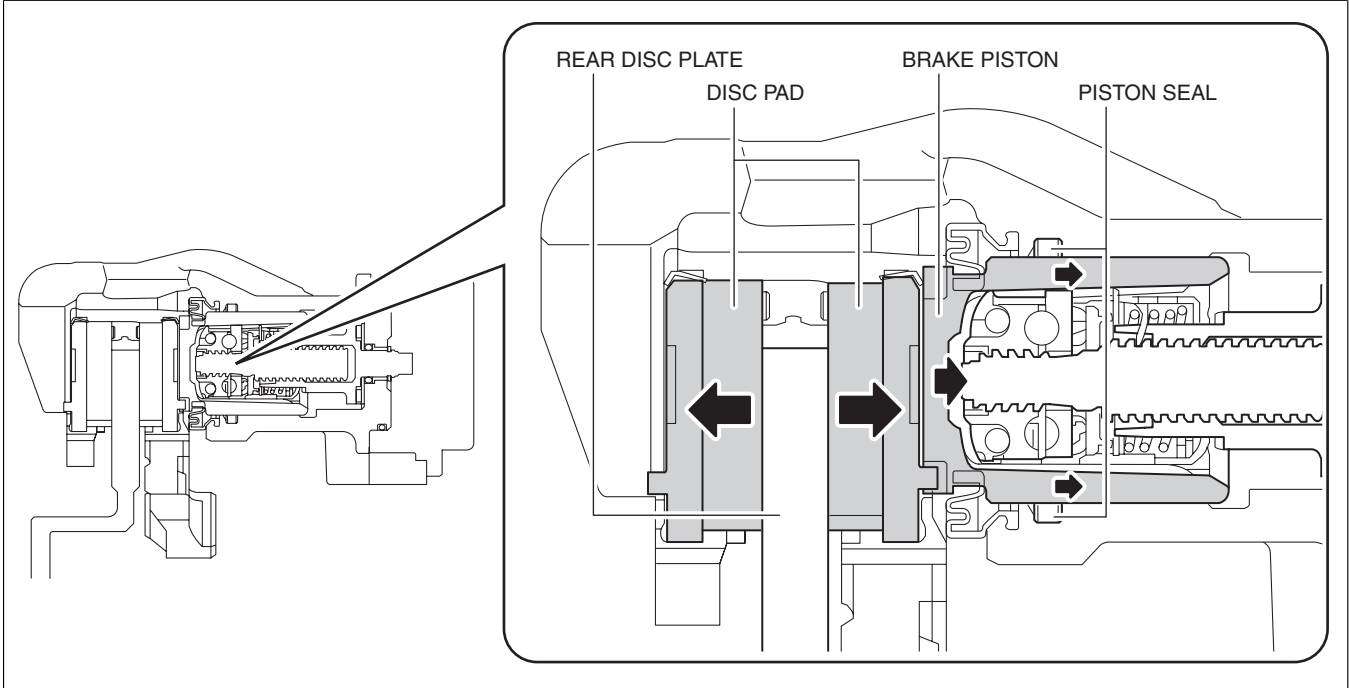

ac5wzn00003534

Fail-safe

- Not applicable.