

# MECHANICAL [FS]

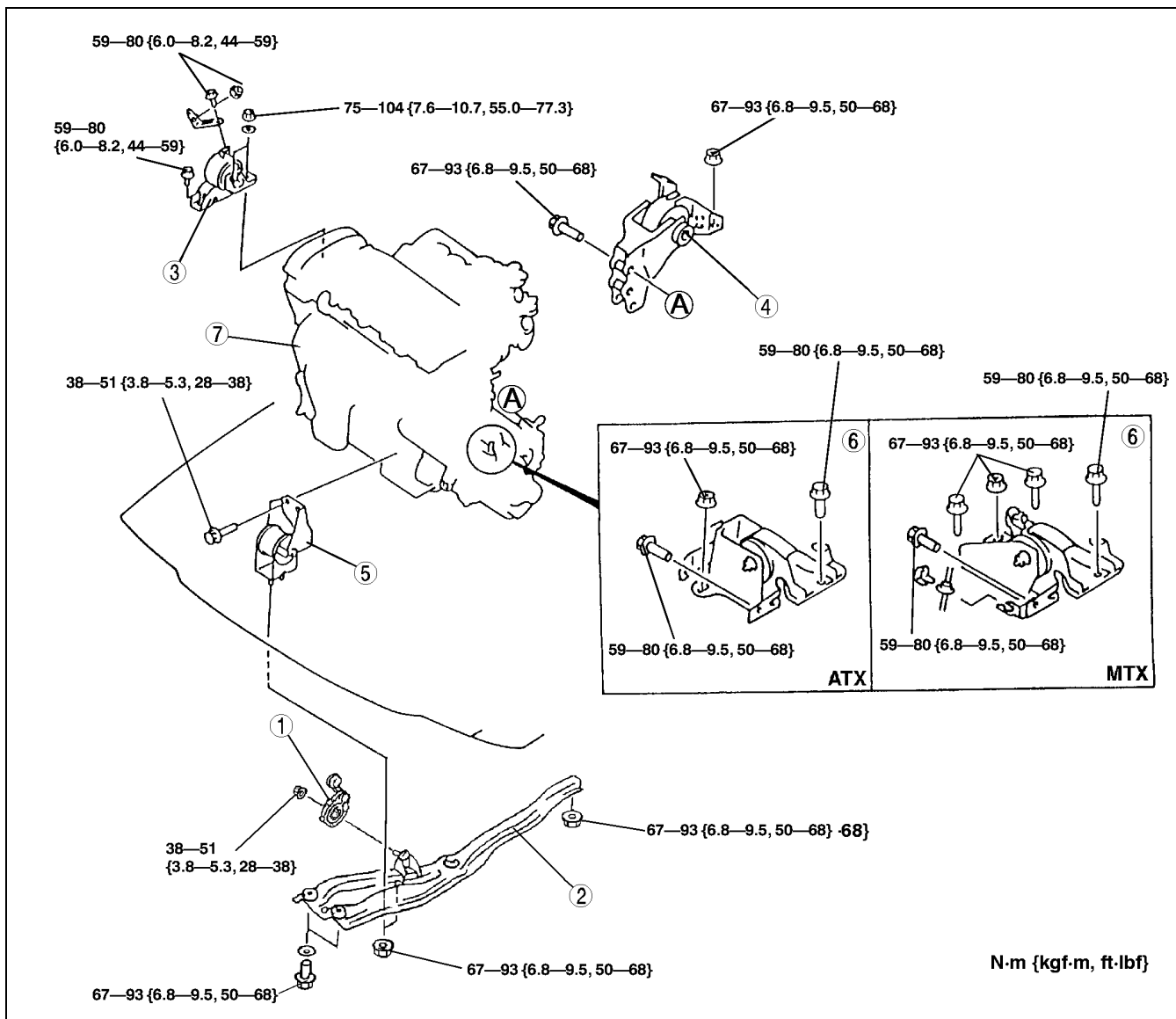

Z3U0110W997

1	Roll damper
2	Engine mount member
3	No.3 Engine mount (See 01-10B-23 No.3, No.4 Engine Mount Installation Note)
4	No.1 Engine mount

5	No.2 Engine mount
6	No.4 Engine mount (See 01-10B-23 No.3, No.4 Engine Mount Installation Note)
7	Engine, transaxle

## Roll damper Installation Note

1. Assemble the rod and roll damper as shown in the figure.

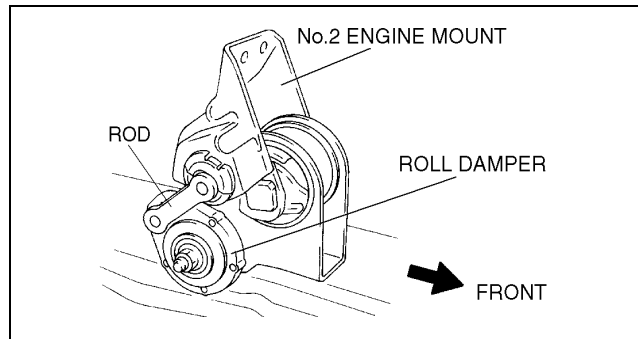

Z3U0110W991

## No.3, No.4 Engine Mount Installation Note

1. Hand tighten the No.3 and No.4 engine mount rubber bolts and nuts (A—M).
2. Tighten the No.4 engine mount rubber bolts and nuts (A—H).
3. Tighten the No.3 engine mount rubber bolts and nuts (I—N)
4. Measure the No.4 engine mount rubber clearance.
  - If not within the specification, repeat from step 1.

### Standard clearance

**3.0—4.0 mm {0.12—0.15 in}**

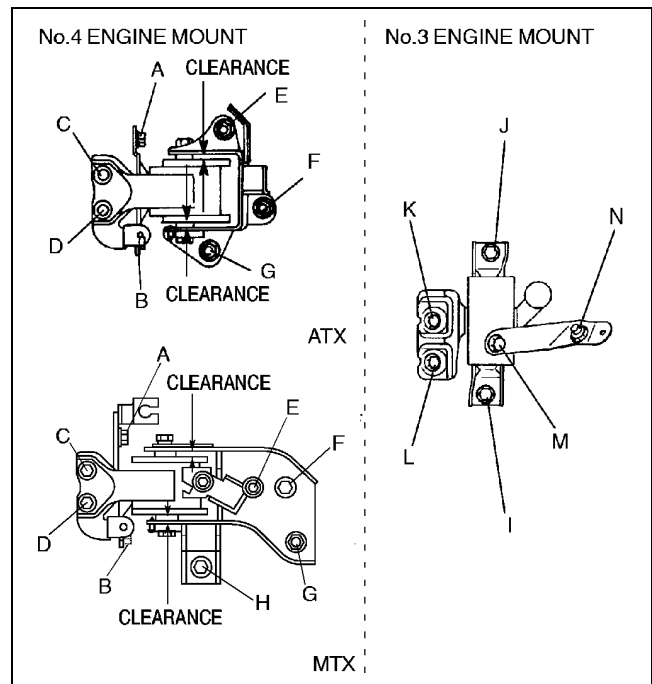

Z3U0110W996

# MANUAL TRANSAXLE [G15M-R]

## Manual Transaxle (MTX) Installation Note

1. Set the transaxle on a jack and lift into place.
2. Install the transaxle mounting bolts.

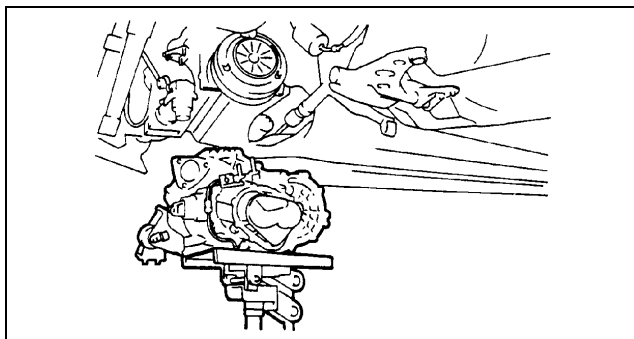

X3U515WA7

## Engine Mount Member Installation Note

1. Verify that the engine mount rubbers are installed as shown.
2. Put the No.2 engine mount stud bolts in the installation holes when installing the engine mount member.

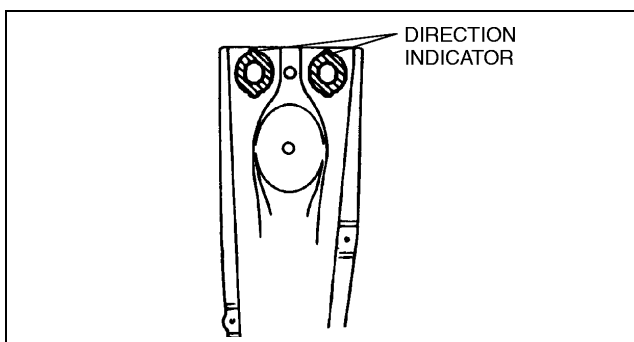

X3U515WA8

3. Tighten bolt A and nut B.

### Tightening torque

**Bolt A:** 67—89 N·m {6.8—9.1 kgf·m, 50—65 ft·lbf}

**Nut B:** 67—93 N·m {6.8—9.5 kgf·m, 50—68 ft·lbf}

4. Tighten nuts C.

### Tightening torque

**Nut C:** 67—93 N·m {6.8—9.5 kgf·m, 50—68 ft·lbf}

5. By aligning the holes with the stud bolts, install the No.4 engine mount bracket to the transaxle.
6. Align the hole of the No.4 engine mount bracket with the No.4 engine mount rubber on vehicle, and temporarily tighten bolt D.
7. Tighten nuts E, then bolt D.

### Tightening torque

**Bolt D and nut E:** 67—93 N·m {6.8—9.5 kgf·m, 50—68 ft·lbf}

8. Remove the **SST** (49 E017 5A0).

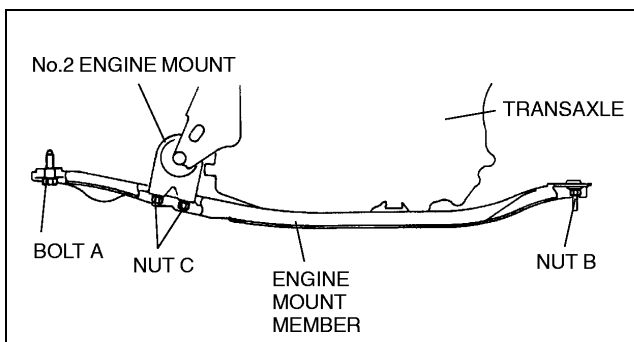

X3U515WA9

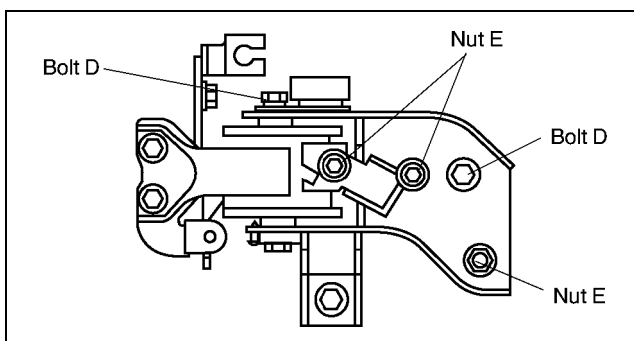

Y3E5212W003