

■ DECORATION PANEL REMOVAL/INSTALLATION

id091700806600

id091700806600

Lower Decoration Panel

1. Disconnect the negative battery terminal. (See NEGATIVE BATTERY TERMINAL DISCONNECTION/CONNECTION.)

2. To prevent scratches or damage, apply protective tape to the position shown in the figure.

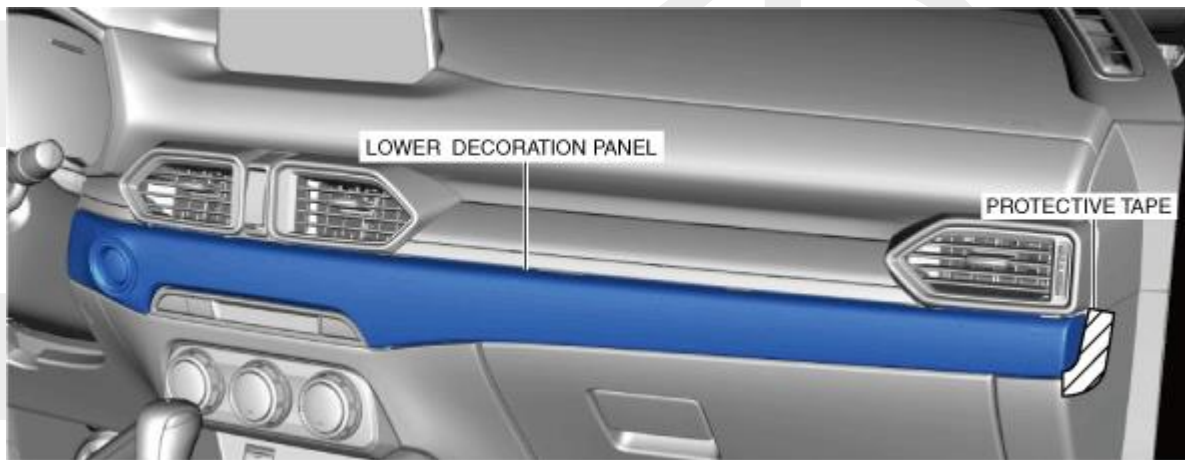

ac5uuw00005298

3. Insert a remover tool into the position shown in the figure.



ac5uuw00005299

4. Move the remover tool in the direction of the arrow shown in the figure and detach the clip.

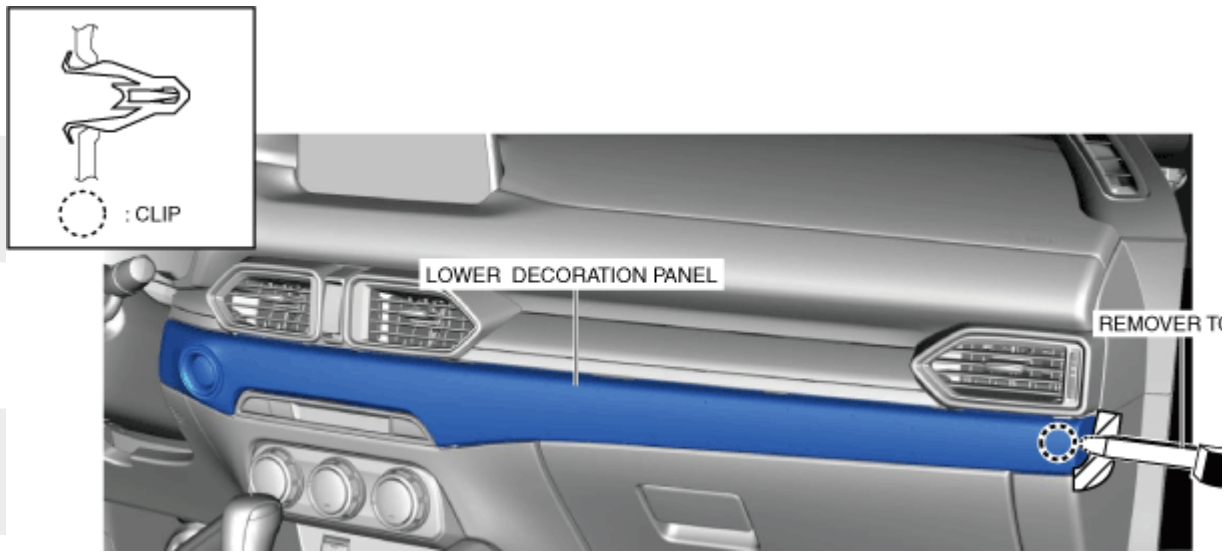

ac5uuw00005300

5. Move the lower decoration panel in the order of arrows (1), (2), (3), and (4) shown in the figure, and remove it while detaching the clips.

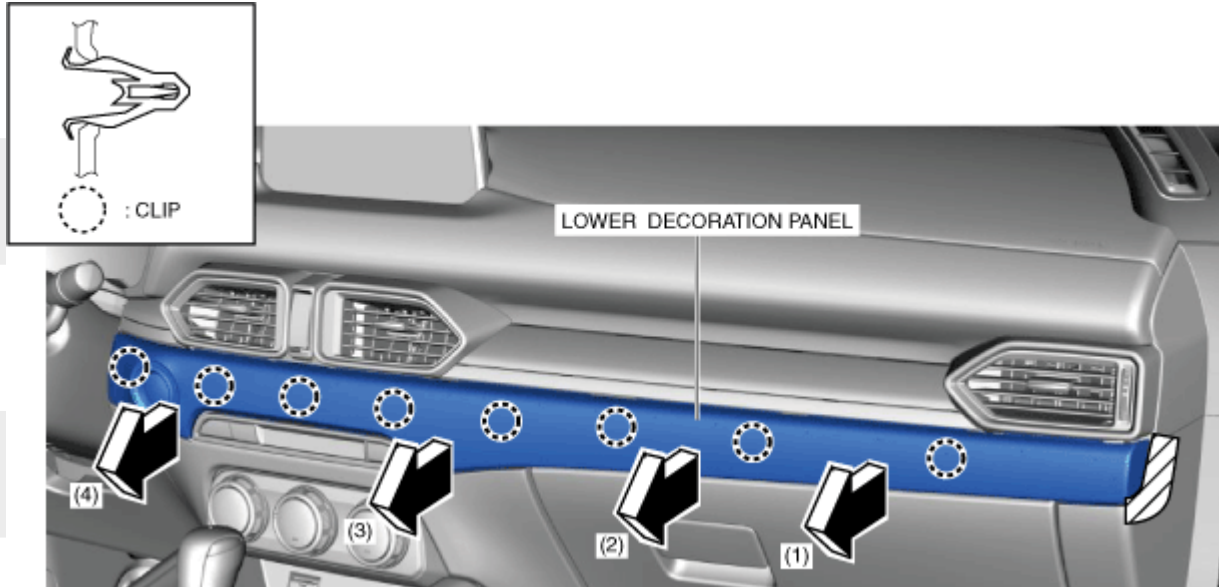

ac5uuw00005301

6. Disconnect the push button start connector.

Note

- When replacing the lower decoration panel, remove the push button start. (See PUSH BUTTON START REMOVAL/INSTALLATION.)

7. Install in the reverse order of removal.

Upper Decoration Panel

1. Disconnect the negative battery terminal. (See NEGATIVE BATTERY TERMINAL DISCONNECTION/CONNECTION.)
2. Remove the lower decoration panel. (See Lower Decoration Panel.)
3. To prevent scratches or damage, apply protective tape to the position shown in the figure.

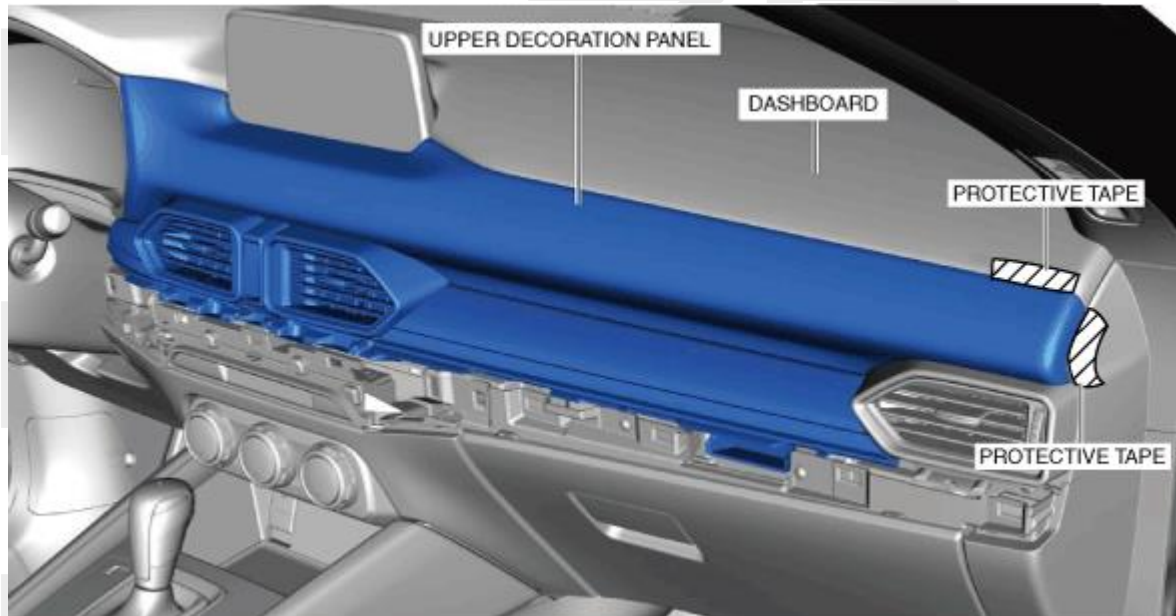

ac5uuw00005302

4. Insert remover tool A into the position shown in the figure and secure a clearance to insert remover tool B.

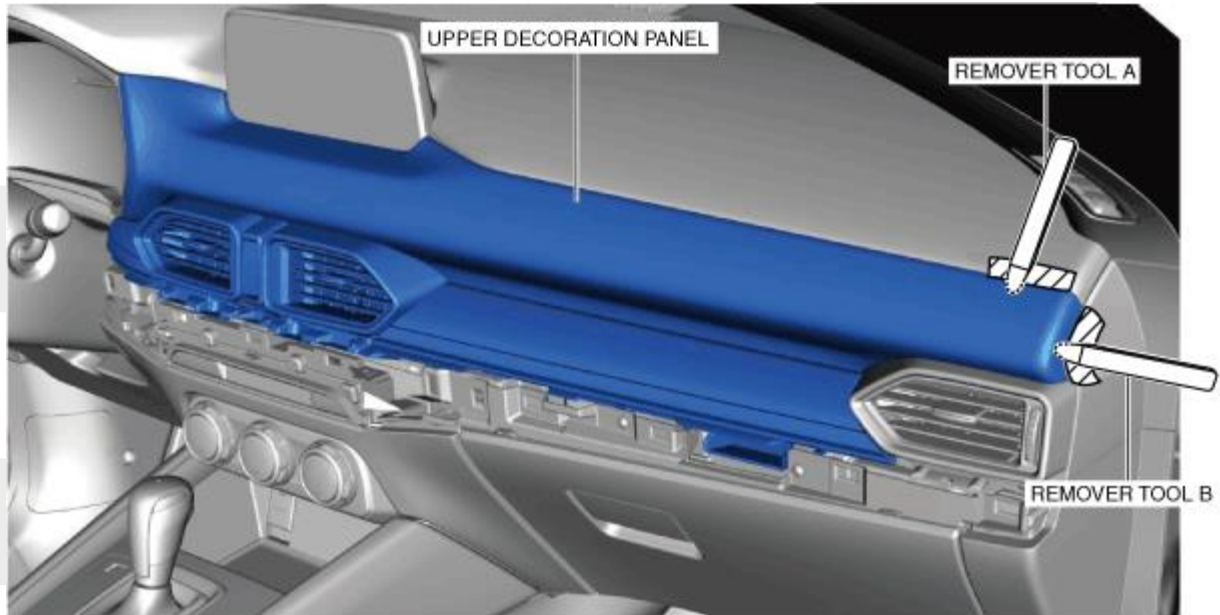

ac5uuw00005303

5. Insert remover tool B into the position shown in the figure.

6. Move remover tools A and B in the direction of the arrows shown in the figure and detach the clip.

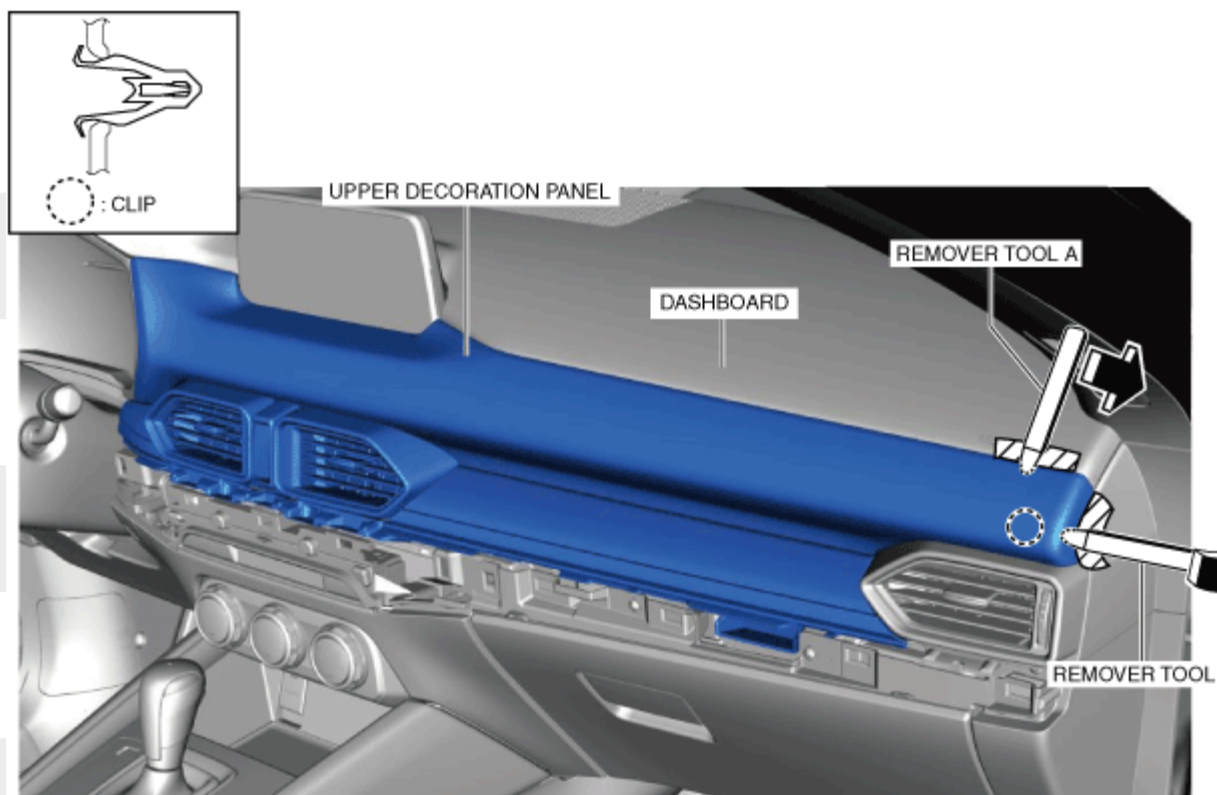

ac5uuw00005304

7. Insert a remover tool into the position shown in the figure.

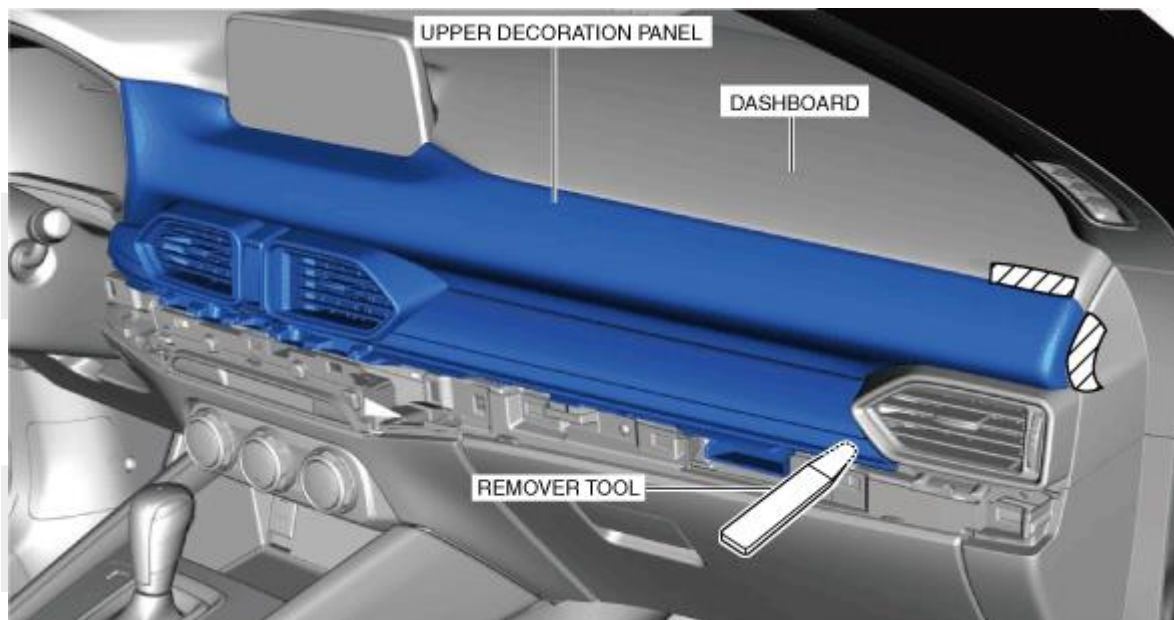

ac5uuw00005305

8. Move the remover tool in the direction of the arrow shown in the figure and detach the clip.

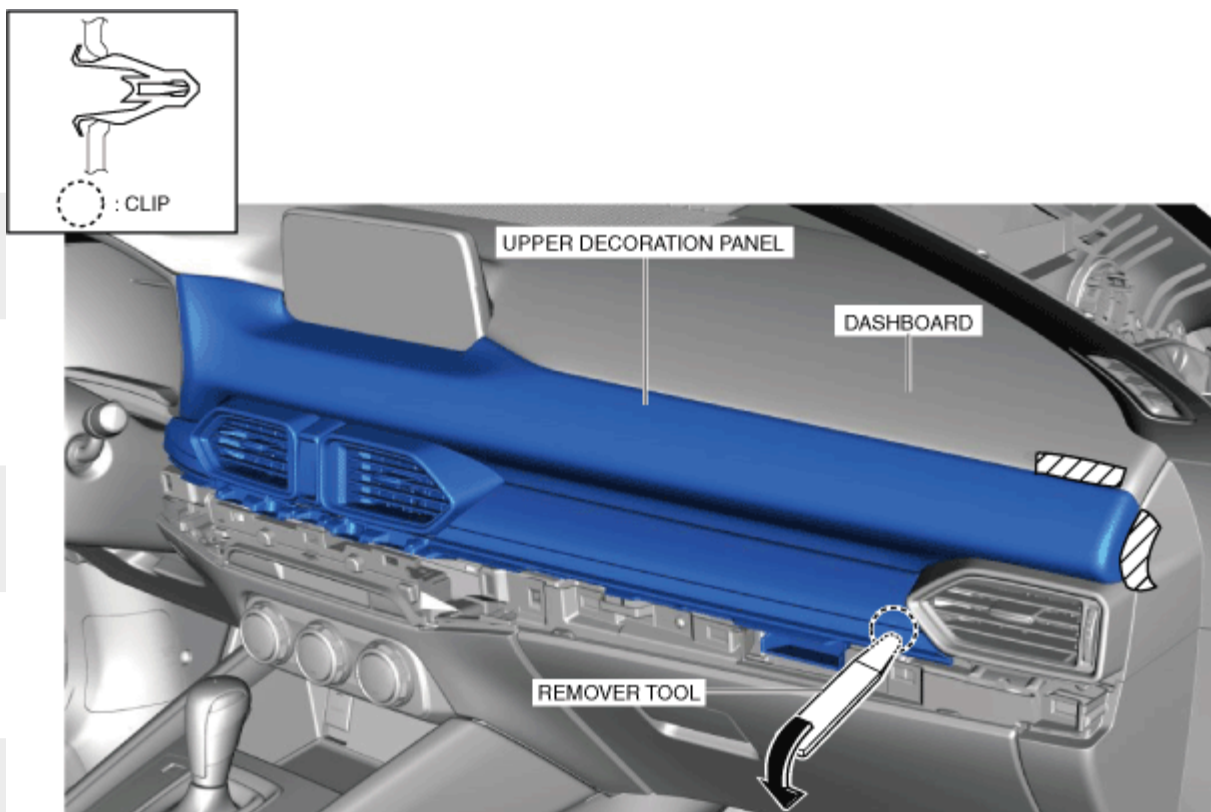

ac5uuw00005306

9. Move the upper decoration panel in the order of arrows (1), (2), (3), and (4) shown in the figure, and remove it while detaching clips A and B.

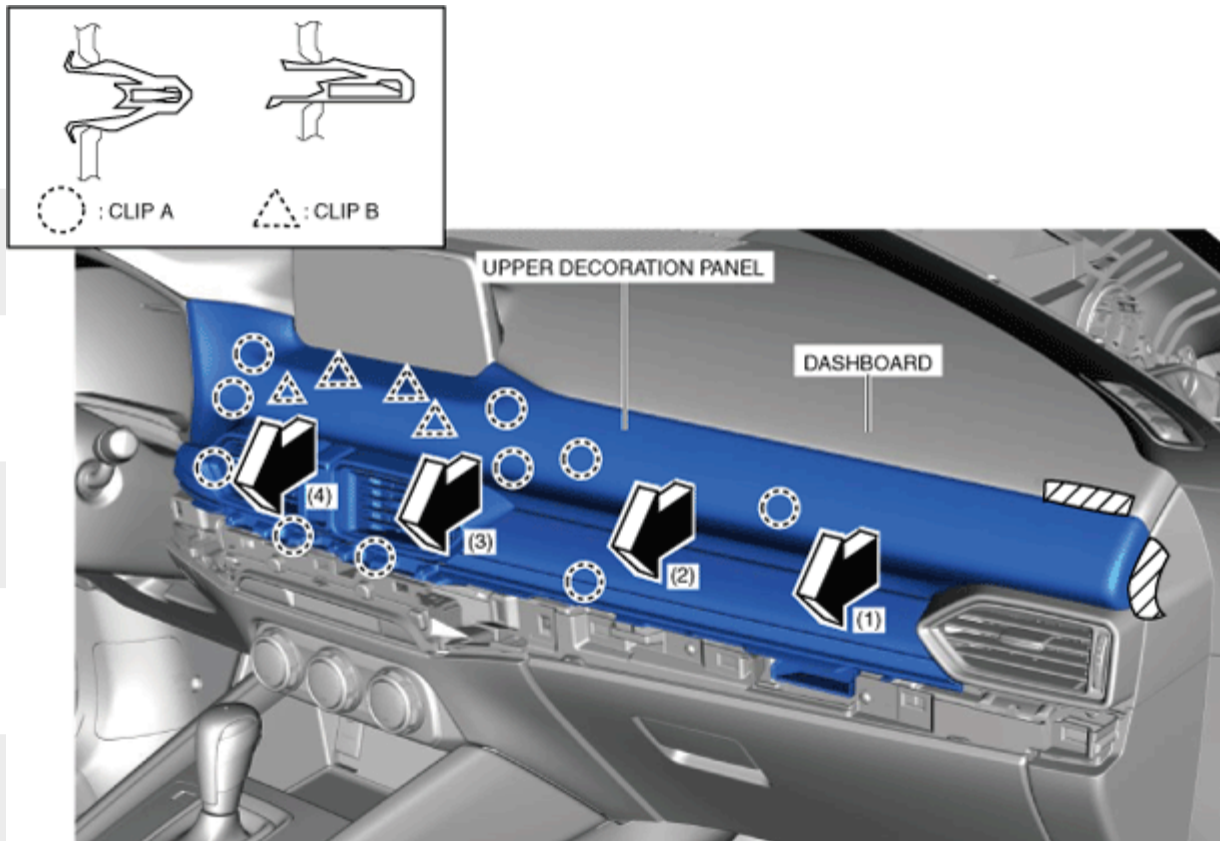

ac5uuw00005307

10. Disconnect the hazard warning switch connector.

Note

- When replacing the upper decoration panel, remove the hazard warning switch. (See HAZARD WARNING SWITCH REMOVAL/INSTALLATION.)
- When replacing the upper decoration panel, remove the center ventilator grilles. (See VENTILATOR GRILLE REMOVAL/INSTALLATION.)

11. Install in the reverse order of removal.

Driver-side Decoration Panel

1. To prevent scratches or damage, apply protective tape to the position shown in the figure.

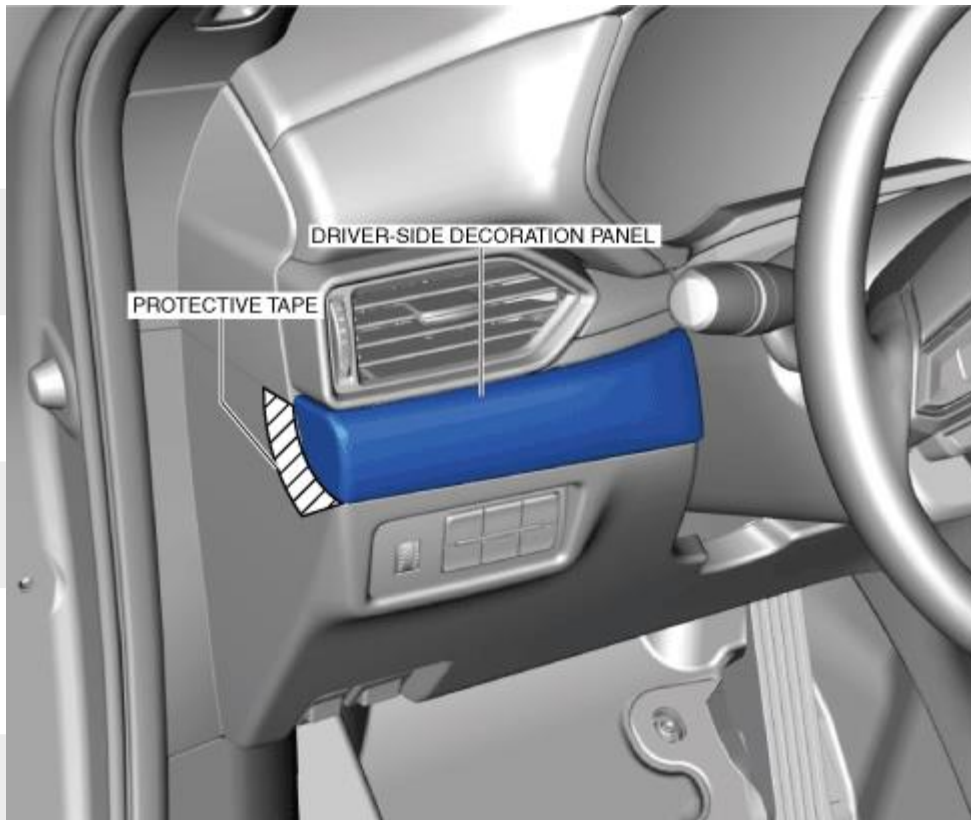

ac5uuw00005308

2. Insert a remover tool into the position shown in the figure.

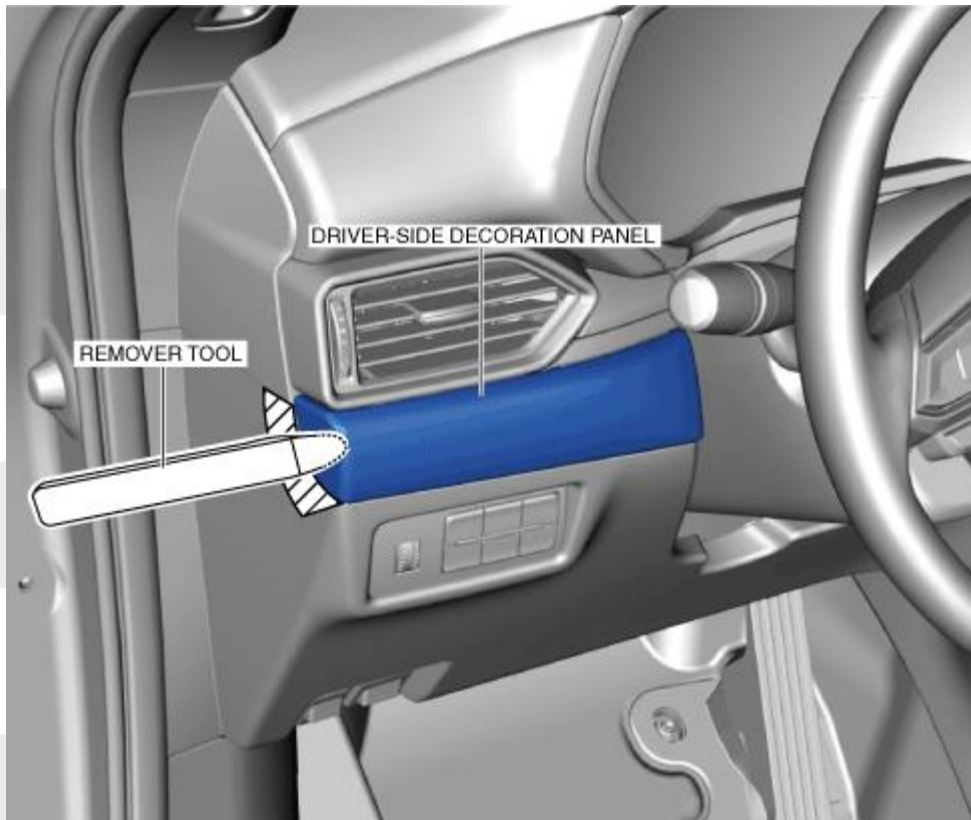

ac5uuw00005309

3. Move the remover tool in the direction of the arrow shown in the figure and detach the clip.

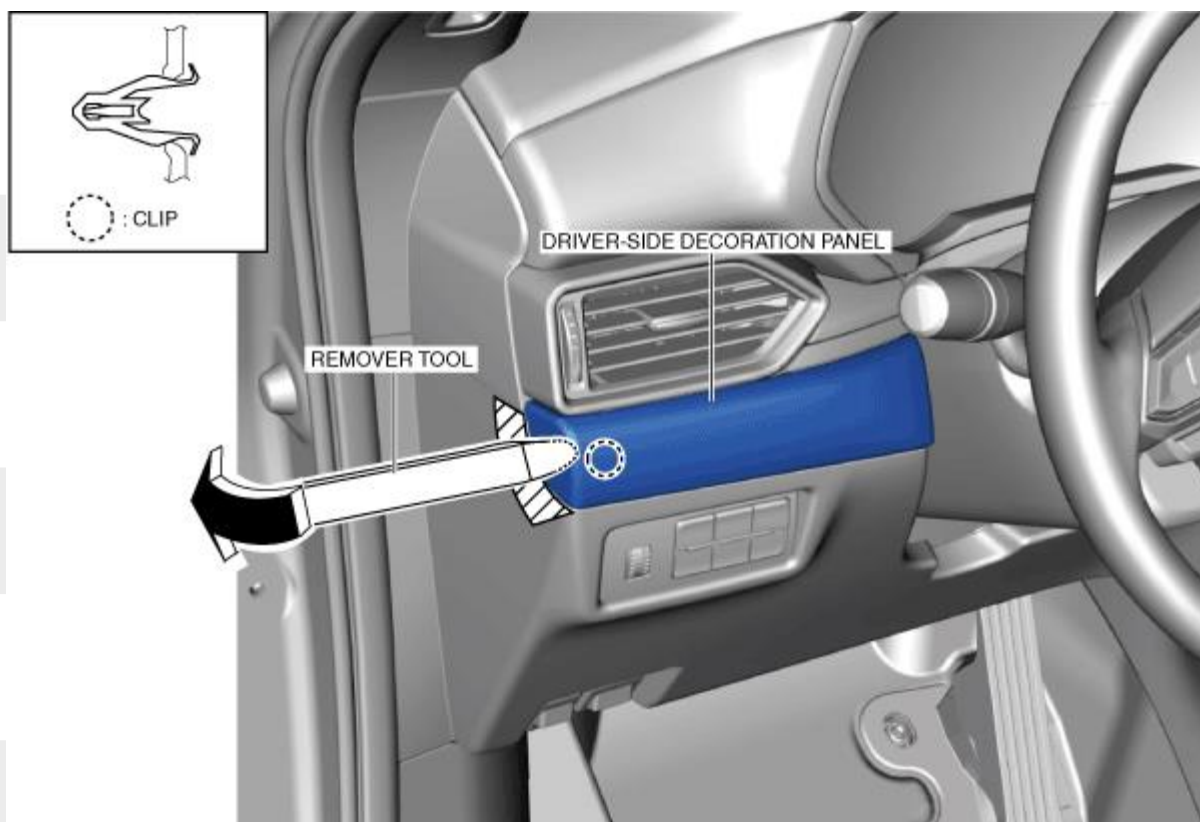

ac5uuw00005310

4. Move the driver-side decoration panel in the direction of the arrow shown in the figure and remove it while detaching the clip.

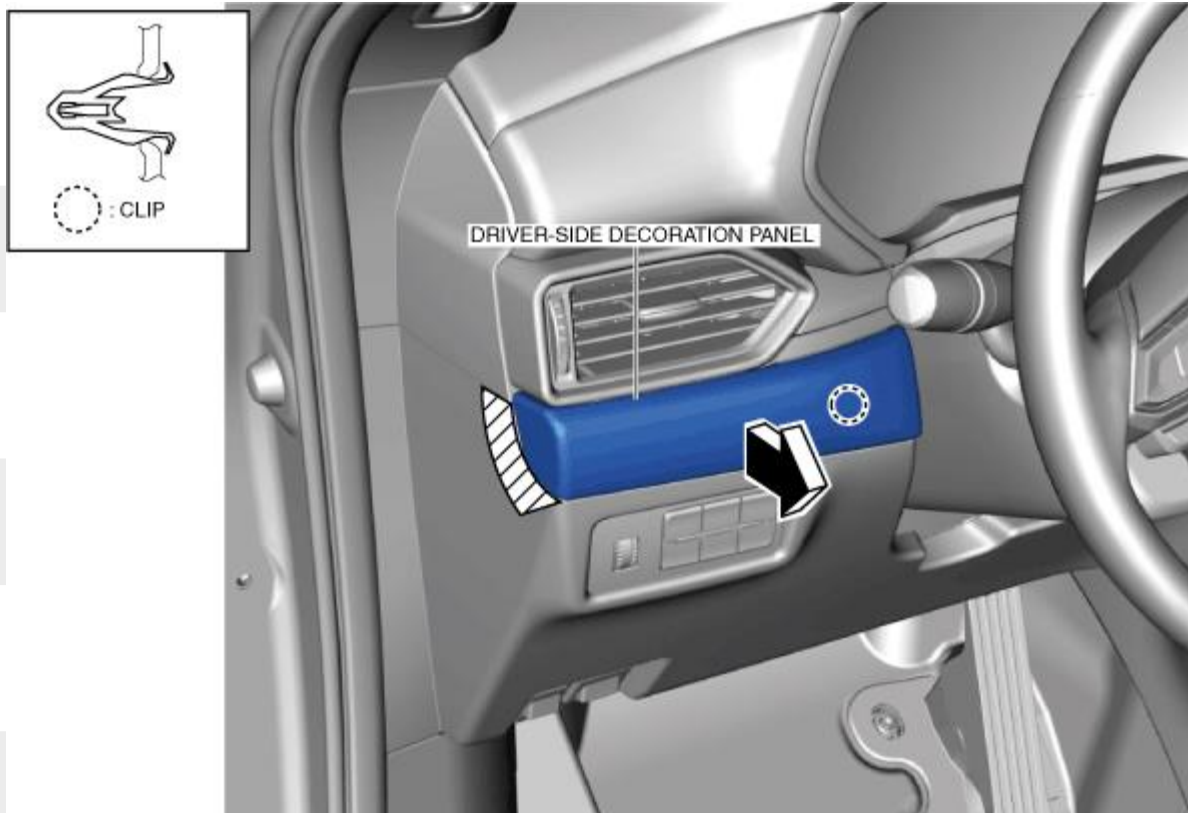

ac5uuw00005311

5. Install in the reverse order of removal.