

< Previous Next >

2013 - CX-5 - Engine

DRIVE BELT [SKYACTIV-G 2.0]

Purpose, Function

- The drive belt transmits rotation force of the crankshaft pulley to the pulley for the auxiliary parts.

Construction

- The drive belt is installed to the front of the engine.

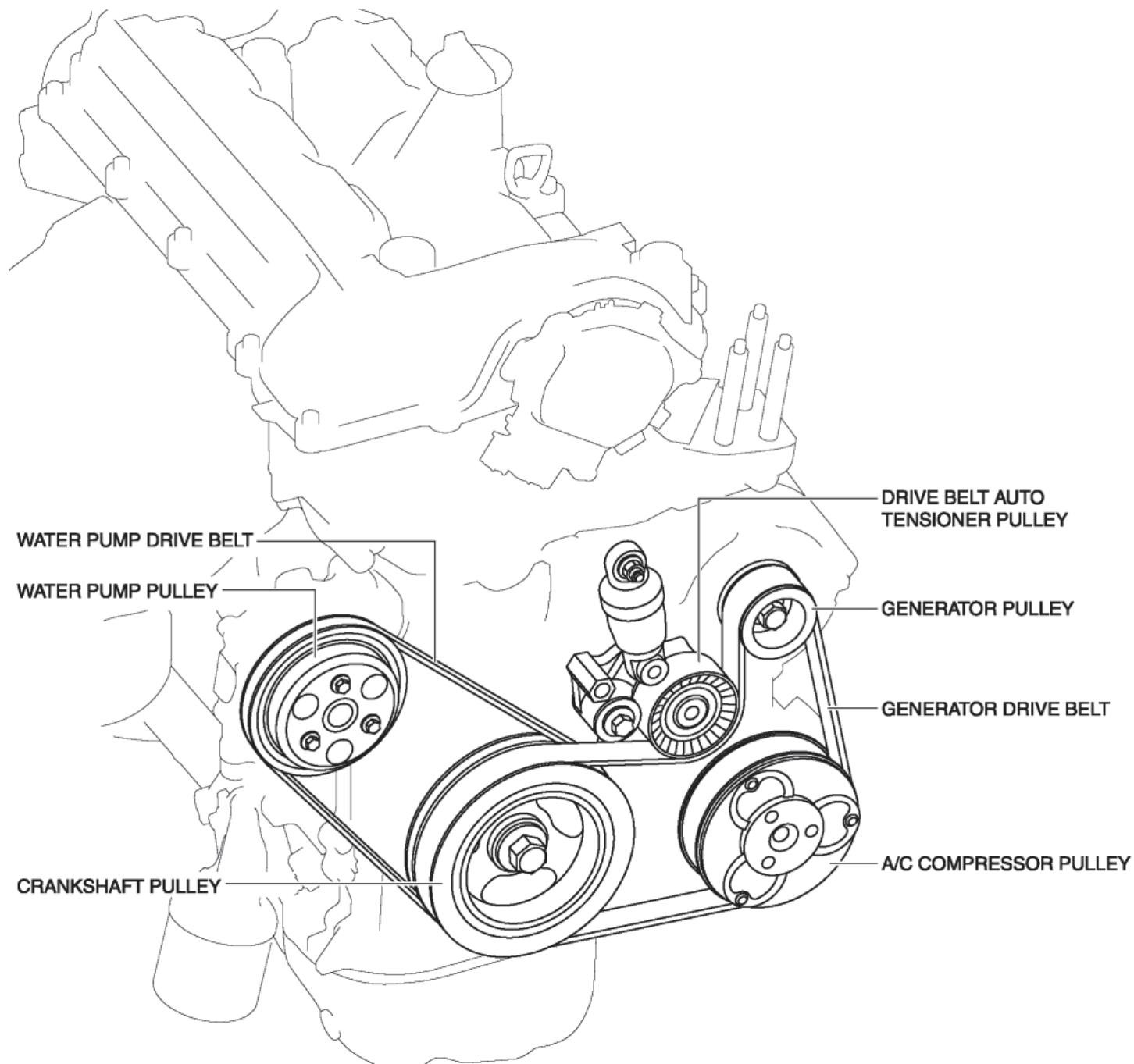

- A V-ribbed belt has been adopted for the drive belt.

- The water pump drive belt is a stretch type.
- Drive belt vibration is suppressed by shortening the distance between each pulley.
- With the adoption of the oil pressure type drive belt auto tensioner, the change in tension by the oil pressure damper operation is absorbed. As a result, the sliding resistance has been reduced by lowering the drive belt tension setting.

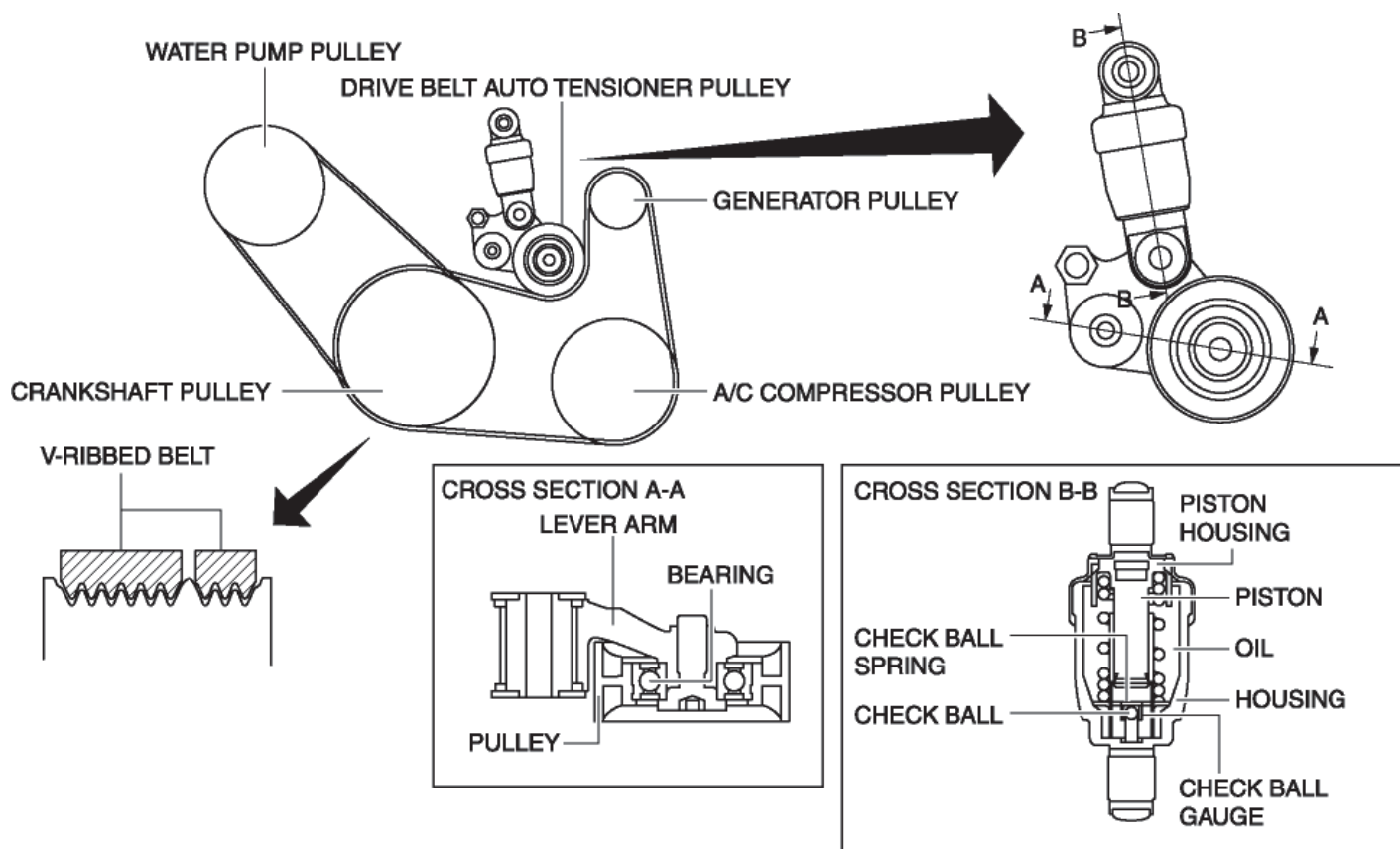

< Previous Next >

[Back to Top](#)

© 2012 Mazda North American Operations, U.S.A.