

<b>Subject:</b>  DRIVER'S DOOR DOES NOT LOCK	<b>Bulletin No:</b> 09-041/06
	<b>Last Issued:</b> 10/12/2006

## APPLICABLE MODEL(S)/VINS

2006 Mazda5 vehicles with VINs lower than JM1CR\*\*\*\*\*125692 (produced before April 17, 2006)

## DESCRIPTION

On some vehicles, the driver's door can be opened from the outside after it is locked with the key or the remote transmitter and the door lock inside the vehicle indicates the door is locked. This is caused by the lock lever of the door lock moving out of position. To fix this problem, the lock position of the lock lever has been enlarged.

Customers having this concern should have their vehicle repaired using the following repair procedure.

## REPAIR PROCEDURE

1. Verify customer concern.
2. Record the customer's radio station presets.
3. Disconnect the negative battery cable.
4. Replace the driver's door lock assembly (door latch and lock actuator) and door lock striker with modified ones. Refer to Workshop Manual section 09-14 FRONT DOOR LATCH AND LOCK ACTUATOR REMOVAL/INSTALLATION and 09-14 DOOR LOCK STRIKER REMOVAL/INSTALLATION.

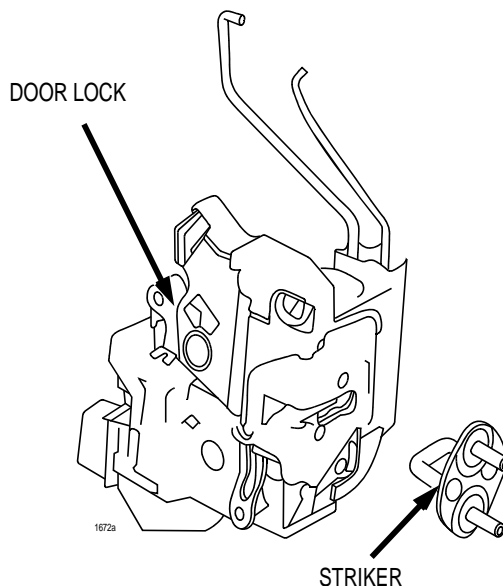

5. Reconnect the negative battery cable.
6. Verify repair.
7. Reset the customer's radio station presets.

<b>Bulletin No:</b> 09-041/06 © 2006 Mazda Motor of America, Inc.	<b>Last Issued:</b> 10/12/2006
--	--------------------------------

## PART(S) INFORMATION

Part Number	Description	Qty.
CD01-59-310	Door Lock Assembly (L)	1
CD73-58-361	Door Striker	1

## WARRANTY INFORMATION

### NOTE:

- This warranty information applies only to verified customer complaints on vehicles eligible for warranty repair. Refer to the Warranty Wizard for warranty term information.
- Additional diagnostic time cannot be claimed for this repair.

Warranty Type	A
Symptom Code	42
Damage Code	9S
Part Number Main Cause	SEE PART(S) INFORMATION
Quantity	1
Operation Number / Labor Hours:	XXB373RX / 0.7 Hrs.