

**Subject:****ENGINE COOLANT LEAKAGE FROM WATER OUTLET****Bulletin No:** 01-047/08**Last Issued:** 10/10/2008

## APPLICABLE MODEL(S)/VINS

2006 - 2008 Mazda3 vehicles (except Mazdaspeed3) with VINs lower than JM1BK3\*\*\*\*\*187397 (produced before July 1, 2008)

2008 Mazda5 vehicles with VINs lower than JM1CR\*\*\*\*\*327438 (produced before July 1, 2008)

## DESCRIPTION

On some vehicles, the engine coolant may leak from the water outlet. This is caused by the gasket making contact with the corner of the water outlet groove. The shape of the water outlet gasket groove and gasket has now been changed.

Customers having this concern should have their vehicle repaired using the following repair procedure.

## REPAIR PROCEDURE

1. Verify customer concern.

**NOTE:** Let the engine cool down before proceeding with the repair.

2. Remove the battery and battery tray with PCM. Refer to MS3 online instructions or Workshop Manual section 01-17.
3. Remove the air cleaner case and cover, and move any hoses or wiring harnesses with brackets to the side. Refer to MS3 online instructions or Workshop Manual section 01-13.
4. Drain the engine coolant. Refer to MS3 online instructions or Workshop Manual section 01-12.
5. Remove the hoses attached to the water outlet and move any other hoses or wiring harnesses to the side to remove the four water outlet bolts.

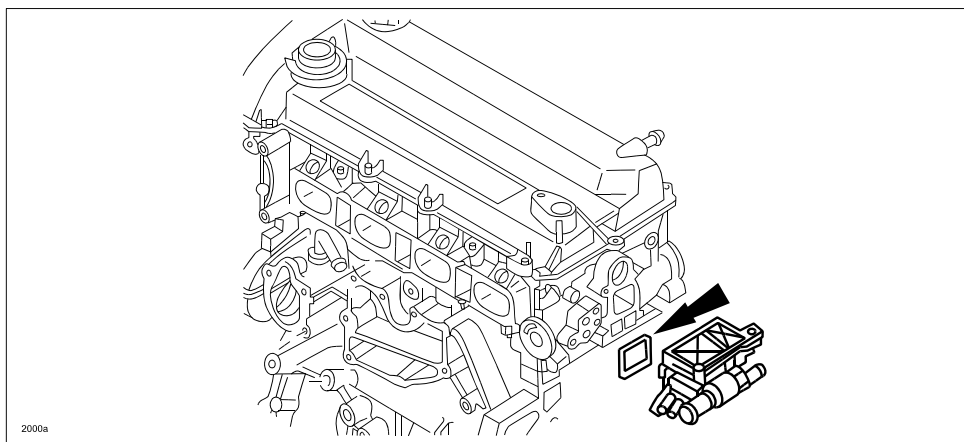

<b>Bulletin No:</b> 01-047/08 © 2008 Mazda Motor of America, Inc.	<b>Last Issued:</b> 10/10/2008
--	--------------------------------

6. Remove the water outlet and replace the gasket with a modified one.

**NOTE:**

- Do not allow mineral oil (engine oil, ATF, or fuel) to get on the gasket.
- Degrease and clean the cylinder head surface and water outlet.

7. Install the water outlet with the four bolts.

Tightening torque: 8.0-11.5 Nm {82-117 kgfcm, 71-101 inlbf}

8. Attach the hoses to the water outlet and place the other hoses and wiring harnesses back into place.

9. Install the air cleaner case and cover, and place the hoses and wiring harnesses with brackets back into place. Refer to MS3 online instructions or Workshop Manual section 01-13.

10. Refill the engine coolant.

11. Install the battery tray with PCM and the battery. Refer to MS3 online instructions or Workshop Manual section 01-17.

12. Verify repair.

## PART(S) INFORMATION

Part Number	Description	Qty.	Notes
LF1F-15-169	Gasket	1	Gasket can be used with new or old water outlet.

## WARRANTY INFORMATION

**NOTE:**

- This warranty information applies only to verified customer complaints on vehicles eligible for warranty repair.
- This repair will be covered under Mazda's New Vehicle Limited Warranty term for a Powertrain Component.
- Additional diagnostic time cannot be claimed for this repair.

Warranty Type	A
Symptom Code	77
Damage Code	9B
Part Number Main Cause	LF1F-15-169
Quantity	1
Operation Number / Labor Hours:	XXD3MXRX / 1.2 Hrs (Mazda3 LF engine) XXD3MXRX / 1.1 Hrs (Mazda3 L3 engine) XXD3MXRX / 0.9 Hrs (Mazda5 L3 engine)